

**NOTICE!!**

**These documents have been scanned!**

**Do not place un-scanned documents beneath this notice!**

**Do not remove this notice from this file!**

GPO Jacket No. 560-102  
Print Order 61540  
Rise Business Services, LLC  
Job=AZ15 5/9/2019



Box Number= AZ15029



Claim Begin-End: AMC430544-AMC430549

1 Initial Receipt

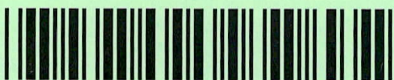

AZ15029-27

AMC430302-AMC430580





**United States Department of the Interior**  
**Bureau of Land Management**  
 LANDS/RECREATION & PLANNING  
 ONE N CENTRAL AVE  
 PHOENIX, AZ 85004 -2203  
 Phone: 602-417-9200

Receipt

No: 3244689

<b>Transaction #:</b> 3339524	
<b>Date of Transaction:</b> 03/06/2015	
CUSTOMER:	
	CHRISTOPHER MILLER 16170 W DYNAMITE BLVD SURPRISE, AZ 85387-6704 US

**ENTERED**  
 MAR 10 2015  
 BY: Ram

LINE #	QTY	DESCRIPTION	REMARKS	UNIT PRICE	TOTAL
1	6.00	LOCATABLE MINERALS / MINING CLAIMS-NEW, UNADJUD, ONE OR MORE AUTH NOS / NEW MINING CLAIMS LOCATION FEE <b>CASES:</b> AMC430544/\$37.00, AMC430545/\$37.00, AMC430546/\$37.00, AMC430547/\$37.00, AMC430548/\$37.00, AMC430549/\$37.00		- n/a -	222.00
2	6.00	LOCATABLE MINERALS / MINING CLAIMS-NEW, UNADJUD, ONE OR MORE AUTH NOS / NEW MINING CLAIM PROCESSING FEE <b>CASES:</b> AMC430544/\$20.00, AMC430545/\$20.00, AMC430546/\$20.00, AMC430547/\$20.00, AMC430548/\$20.00, AMC430549/\$20.00		- n/a -	120.00
3	6.00	LOCATABLE MINERALS / MINING CLAIMS-NEW, UNADJUD, ONE OR MORE AUTH NOS / NEW MINING CLAIMS MAINTENANCE FEE <b>CASES:</b> AMC430544/\$155.00, AMC430545/\$155.00, AMC430546/\$155.00, AMC430547/\$155.00, AMC430548/\$155.00, AMC430549/\$155.00		- n/a -	930.00
<b>TOTAL:</b>					<b>\$1,272.00</b>

PAYMENT INFORMATION			
1	AMOUNT:	212.00	POSTMARKED: 03/03/2015
	TYPE:	CHECK	RECEIVED: 03/05/2015
	CHECK NO:	1220	
	NAME:	ANDERSON, JEANETTE 16170 W DYNAMITE BLVD SURPRISE AZ 85387-6704 US	
2	AMOUNT:	212.00	POSTMARKED: 03/03/2015

	TYPE:	CHECK	RECEIVED:	03/05/2015
	CHECK NO:	1221		
	NAME:	ANDERSON, JEANETTE 16170 W DYNAMITE BLVD SURPRISE AZ 85387-6704 US		
3	AMOUNT:	212.00	POSTMARKED:	03/03/2015
	TYPE:	CHECK	RECEIVED:	03/05/2015
	CHECK NO:	1222		
	NAME:	ANDERSON, JEANETTE 16170 W DYNAMITE BLVD SURPRISE AZ 85387-6704 US		
4	AMOUNT:	212.00	POSTMARKED:	03/03/2015
	TYPE:	CHECK	RECEIVED:	03/05/2015
	CHECK NO:	1223		
	NAME:	ANDERSON, JEANETTE 16170 W DYNAMITE BLVD SURPRISE AZ 85387-6704 US		
5	AMOUNT:	212.00	POSTMARKED:	03/03/2015
	TYPE:	CHECK	RECEIVED:	03/05/2015
	CHECK NO:	1224		
	NAME:	ANDERSON, JEANETTE 16170 W DYNAMITE BLVD SURPRISE AZ 85387-6704 US		
6	AMOUNT:	212.00	POSTMARKED:	03/03/2015
	TYPE:	CHECK	RECEIVED:	03/05/2015
	CHECK NO:	1226		
	NAME:	ANDERSON, JEANETTE 16170 W DYNAMITE BLVD SURPRISE AZ 85387-6704 US		

REMARKS

This receipt was generated by the automated BLM Collections and Billing System and is a paper representation of a portion of the official electronic record contained therein.



**NOTICE!!**

**These documents have been scanned!**

**Do not place un-scanned documents beneath this notice!**

**Do not remove this notice from this file!**

GPO Jacket No. 560-102  
Print Order 61540  
Rise Business Services, LLC  
Job=AZ15 5/9/2019



Box Number= AZ15029



Claim Begin-End: AMC430544-AMC430549

2 Correspondence



AZ15029-27

AMC430302-AMC430580

**NO  
DOCUMENTS  
FOUND**

NO DOCUMENTS FOUND  
NO DOCUMENTS FOUND



**NOTICE!!**

**These documents have been scanned!**

**Do not place un-scanned documents beneath this notice!**

**Do not remove this notice from this file!**

GPO Jacket No. 560-102  
Print Order 61540  
Rise Business Services, LLC  
Job=AZ15 5/9/2019



Box Number= AZ15029



Claim Begin-End: AMC430544-AMC430549

3 Transfers



AZ15029-27

AMC430302-AMC430580



**NO  
DOCUMENTS  
FOUND**

NO DOCUMENTS FOUND  
NO DOCUMENTS FOUND

**NOTICE!!**

**These documents have been scanned!**

**Do not place un-scanned documents beneath this notice!**

**Do not remove this notice from this file!**

GPO Jacket No. 560-102  
Print Order 61540  
Rise Business Services, LLC  
Job=AZ15 5/9/2019



Box Number= AZ15029



Claim Begin-End: AMC430544-AMC430549

4 Annual Filings



AZ15029-27

AMC430302-AMC430580

Amc 430544

Amc 427452

**DOCUMENTS RECEIVED  
WITHOUT CHECK/PAYMENT**

Received from: Christopher Miller  
16170 West Dynamite Blvd  
Surprise, AZ 85387

Number of pages: 11

Date Received: 8/31/18

Method of delivery: UPS

Tracking #: UPS Ground 1Z V31 689 42 2259 3860

**MAILROOM**

Signature: Pamela Davis  
Printed Name: Pamela Davis

Date: 8/31/18

**PUBLIC ROOM**

Signature: Phyllis Ralley  
Printed Name: PHYLLIS RALLEY

Date: 8/31/18

**SUPERVISOR**

Signature: \_\_\_\_\_  
Printed Name: \_\_\_\_\_

Date: \_\_\_\_\_

*called and  
left msg  
9/4/18*

*called back 9/4/18 -  
paid w/ cc  
me*



To whom it may concern.

Please find enclosed the paperwork for 7 claims.

I did not find the form for "Notice of Intent to Hold" which I believe is not required after the first year??

Please inform me if any changes need to be made or of any errors and/or discrepancies.

Please find enclosed a check for the small Miner waiver.

Please contact if any other questions arise.

Thank You

Christopher A Miller  
16170 West Dynamite BLVD  
Surprise AZ 85387  
623-687-6538

RECEIVED  
BLM AZ STATE OFFICE  
2010 AUG 31 A 11: 18  
PHOENIX, ARIZONA



Amc 430544 - Amc 430549  
Amc 427452

Rm  
9/7/18

**United States Department of the Interior**  
**Bureau of Land Management**  
 DIV OF LANDS, MINRLS & ENERGY  
 ONE N CENTRAL AVE  
 PHOENIX, AZ 85004 -4427  
 Phone: 602-417-9200

Receipt

No: 4255130

<b>Transaction #:</b> 4370665	
<b>Date of Transaction:</b> 09/04/2018	
<b>CUSTOMER:</b>	
CHRISTOPHER MILLER 16170 W DYNAMITE BLVD SURPRISE, AZ 85387-6704 US	

LINE #	QTY	DESCRIPTION	REMARKS	UNIT PRICE	TOTAL
1	1.00	LOCATABLE MINERALS / MINING CLAIMS-NOT NEW-UNADJUD, ONE AUTH NO. ONLY / MINING CLAIM MONEY RECEIVED CASES: AMC427452/\$70.00	POL 2018/7 WAV MAINT 2019/7	- n/a -	70.00
<b>TOTAL:</b>					<b>\$70.00</b>

PAYMENT INFORMATION			
NOTE: Items will appear on credit card statement as "Bureau of Land Mgmt CO".			
1	AMOUNT:	70.00	POSTMARKED: N/A
	TYPE:	CREDIT CARD	RECEIVED: 09/04/2018
	NAME:	MILLER, CHRISTOPHER 16170 W DYNAMITE BLVD SURPRISE AZ 85387-6704 US	
	CARD NO:	XXXXXXXXXXXX6933	AUTH CODE: 061115
	NAME ON CARD:	C A M	
	SIGNATURE:		

REMARKS

This receipt was generated by the automated BLM Collections and Billing System and is a paper representation of a portion of the official electronic record contained therein.

CHRISTOPHER MILLER  
(623) 687-6538  
THE UPS STORE #4070  
15508 W BELL RD  
SURPRISE AZ 85374-2432

1 LBS 1 OF 1  
SHP WT: 1 LBS  
DATE: 30 AUG 2018

SHIP BLM AZ OFFICE  
TO: STE 800  
1 N CENTRAL AVE

PHOENIX AZ 85004-4427

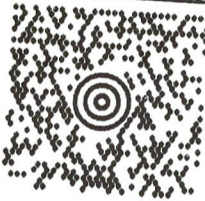

AZ 850 9-10



UPS GROUND

TRACKING #: 1Z V31 689 42 2259 3860



BILLING: P/P  
SIGNATURE REQUIRED

REF #1: CR



SEE NOTICE ON REVERSE regarding UPS terms, and notice of limitation of liability. Where allowed by law, shipper authorizes UPS to act as a customs broker for export control and customs purposes. If exported from the US, shipper certifies that the commodities, technology or software were exported from the US in accordance with the Export Administration Regulations. Diversion contrary to law is prohibited.

ISH 13.00N ZZZ 03.5 07/2018

PHOENIX, ARIZONA

2018 AUG 31

BLM AZ STATE OFFICE

RECEIVED

11:18





TRAL AVE  
AZ 85004

TOWN OF ORANGE

04-4246

1689422259 3800  
2485 P99 31 07-18 19 2818  
01 HIFPS 18.09. SHT034855L

305

UNITED STATES  
DEPARTMENT OF THE INTERIOR  
BUREAU OF LAND MANAGEMENT

FORM APPROVED  
OMB NO.: 1004-0114  
Expires: January 31, 2020

430544

427452

**AFFIDAVIT OF ANNUAL ASSESSMENT WORK**

WHEN RECORDED, MAIL DOCUMENT TO:

NAME: CHRISTOPHER A MILLER

ADDRESS: 16170 WEST DYNAMITE BLVD

CITY, STATE, ZIP: SURPRISE AZ 85387

FOR COUNTY RECORDER'S USE

No. of Claims 7

x \$10/claim

Total due BLM \$ 70.00

TO ALL WHOM IT MAY CONCERN:

1. The undersigned certifies that at least \$100 per claim was expended for development, labor and improvements, or equivalent value added, as the annual assessment work for the assessment year ending September 1, 2018 for the following contiguous unpatented mining claim(s), located in the County of YAVAPIA, in the State of ARIZONA.

BLM Serial No.	Name of Claim	Tp	Rg	Sec	Mer	County Recordation Book and Page No.	Co. Recording Date
427452	MAVERICK	11N	1E	26			
430544	MAVERICK-2	11N	1E	26			
430545	MAVERICK-3	11N	1E	26			
430546	MAVERICK-4	11N	1E	26			
430547	MAVERICK-5	11N	1E	26			
430548	MAVERICK-6	11N	1E	26			
430549	MAVERICK-7	11N	1E	26			

RECEIVED  
 BLM AZ STATE OFFICE  
 2018 AUG 31 A 11:18  
 PHOENIX, ARIZONA

# 4255130  
**ENTERED**  
 SEP 07 2018  
 BY: RAM



2. Type of labor and improvements (specify what was done and give the total value for that labor and improvement to show at least \$100 for each claim). If a geological, geochemical, or geophysical survey was performed, as per 30 U.S.C. 28-1, reference the title of the report of survey, give cost and date of the survey and report, and indicate it was filed with the County Recorder:

Description of Work Performed	Value of Work Performed	Date Work Was Performed
CLEANING UP TRASH, MINING AND MAINTAINING SIGNS ETC	1000.00	2017-2018

3. Name and mailing address of each person who performed the labor and improvements:

<b>Name (please print)</b> CHRISOPHER A MILLER	<b>Current Mailing Address (please print)</b> 16170 WEST DYNAMIOTE BLVD
_____	_____
_____	_____
_____	_____

4. Name and mailing address of each person who holds and claims the subject mining claim(s) for the valuable minerals contained therein. Be sure to indicate if there is a change of address:

<b>Name (please print)</b> CHRISTOPHER A MILLER	<b>Current Mailing Address (please print)</b> 16170 WEST DYNMAITE BLVD
_____	_____
_____	_____
_____	_____
_____	_____
_____	_____

RECEIVED  
 BLM AZ STATE OFFICE  
 2018 AUG 31 A 11:18  
 PHOENIX, ARIZONA

5. The undersigned testifies that on the date of 8/30, 2018, all monuments required by law were erected upon the subject claim(s), and all notices required by law were posted on the subject claim(s) or copies thereof were in place, and at said date, each corner monument bore or contained



markings sufficient to appropriately designate the corner of the claim to which it pertains and the name of the claim(s).

I hereby certify under penalty of perjury under the laws of the State of ARIZONA that the foregoing statements are true and correct:

[Signature] Date: 8/30/2018  
(Signature of person responsible for above statement)

Title 18 U.S.C. 1001 and 43 U.S.C. 1212 make it a crime for any person knowingly and willfully to make to any department or agency of the United States any false, fictitious or fraudulent statements or representations as to any matter within its jurisdiction.

**Notary Block**

SUBSCRIBED AND SWORN TO before me, this 30<sup>th</sup> day of August 2018

By: [Signature]  
(Signature of Affiant)

Title: Notary

My Commission Expires: Nov 10, 2020

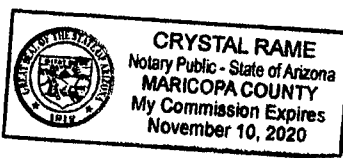

**INSTRUCTIONS**

1. This is an optional form that may be used to satisfy the requirements for the Bureau of Land Management (BLM) under the provisions of 43 U.S.C. §1744 and 30 U.S.C. §28-28d and the regulations thereunder (43 CFR part 3835). Since local and State laws may vary, you should contact your local and State agencies where the claims are located to ensure all applicable laws and requirements are satisfied.
2. The claimant(s) must fill in the date in paragraph 1 for the applicable assessment year and the county and state where the claims are located.
3. All claim names, BLM serial numbers, legal descriptions, and original county recording information must be listed for the claims pertaining to this assessment notice.
4. The claimant(s) must complete paragraph 2 listing all labor or improvements which was performed on or did benefit the subject mining claims. The value and date of the labor or improvements must also be listed. The total amount of labor or improvements can be listed, but the total expenditure must equal at least \$100 for each claim.
5. The names and current mailing addresses of the person(s) performing the labor shall be listed in paragraph 3.
6. The name and current mailing address of each owner (claimant) of the claims shall be listed in paragraph 4. The mailing address shall be the owner's address and not the address of an agent or anyone representing the claimant. Be sure to note if there has been a change of address.
7. Paragraph 5 shall be completed to show the date it was verified that all monuments required by law were properly erected, all notices were posted, and that corners were appropriately designated for all claims listed.
8. An exact legible reproduction or duplicate (other than microfilm or other electronic media) of this affidavit or another type of affidavit of assessment work that you file or will file in the county where each claim is located, must be filed with the BLM on or before December 30 of the calendar year in which the assessment year ends. For mill or tunnel sites, a separate notice of intent to hold must be filed with the BLM on or before December 30. Requirements for filing a notice of intent to hold can be found at 43 CFR 3835.33.
9. A processing fee of \$10 for each claim listed must be remitted to the BLM along with this or any other affidavit of assessment work.

UNITED STATES  
DEPARTMENT OF THE INTERIOR  
BUREAU OF LAND MANAGEMENT  
**MAINTENANCE FEE PAYMENT FORM  
FOR PLACER MINING CLAIMS**

Remitter Name: Christopher A Miller  
 Mailing Address: 16170 West Dynamite BLVD  
 City, State, Zip: Surprise AZ 85387

Check here if this is a change of address.

**FOR COUNTY RECORDER'S USE**

No. of claims 7  
 Total due BLM \$ 70.00

- The maintenance fee may be paid by cash, check, money order, Bureau of Land Management (BLM) Declining Deposit Account, or credit card (VISA, American Express, Discover, or MasterCard). Payments must be remitted to the BLM State Office where your claim or site is recorded and received on or before September 1. If the payment is mailed, the envelope must be postmarked by a bona fide delivery service on or before September 1 and received at the proper BLM State Office within 15 calendar days after the due date. Payments may also be made by telephone using a credit card. A complete listing of BLM State Offices with their addresses and phone numbers can be found at <http://www.blm.gov>.
- The maintenance fee for the following claim(s) applies to the assessment year 2019.

CLAIM NAME	BLM SERIAL NO.	ACRES IN CLAIM	PAYMENT DUE TO THE BLM (See Instructions on Page 2)
MAVERICK	427452	20	10
MAVERICK-2	430544	20	10
MAVERICK-3	430545	20	10
MAVERICK-4	430546	20	10
MAVERICK-5	430547	20	10
MAVERICK-6	430548	20	10
MAVERICK-7	430549	20	10

RECEIVED  
 BLM AZ STATE OFFICE  
 2019 AUG 31 4:11:18  
 PHOENIX, ARIZONA

Use a separate sheet for additional claim names, serial numbers, and claimant names and addresses.

**United States Department of the Interior**  
**Bureau of Land Management**  
 DIV OF LANDS, MINRLS & ENERGY  
 ONE N CENTRAL AVE  
 PHOENIX, AZ 85004 -4427  
 Phone: 602-417-9200

Receipt

No: 4255130

<b>Transaction #:</b> 4370665	
<b>Date of Transaction:</b> 09/04/2018	
CUSTOMER:	
CHRISTOPHER MILLER 16170 W DYNAMITE BLVD SURPRISE, AZ 85387-6704 US	

LINE #	QTY	DESCRIPTION	REMARKS	UNIT PRICE	TOTAL
1	1.00	LOCATABLE MINERALS / MINING CLAIMS-NOT NEW-UNADJUD, ONE AUTH NO. ONLY / MINING CLAIM MONEY RECEIVED CASES: AMC427452/\$70.00	POL 2018/7 WAV MAINT 2019/7	- n/a -	70.00
<b>TOTAL:</b>					<b>\$70.00</b>

PAYMENT INFORMATION				
NOTE: Items will appear on credit card statement as "Bureau of Land Mgmt CO".				
1	AMOUNT:	70.00	POSTMARKED:	N/A
	TYPE:	CREDIT CARD	RECEIVED:	09/04/2018
	NAME:	MILLER, CHRISTOPHER 16170 W DYNAMITE BLVD SURPRISE AZ 85387-6704 US		
	CARD NO:	XXXXXXXXXXXX6933	AUTH CODE:	061115
	NAME ON CARD:	C A M		
	SIGNATURE:			

REMARKS

This receipt was generated by the automated BLM Collections and Billing System and is a paper representation of a portion of the official electronic record contained therein.



UNITED STATES  
DEPARTMENT OF THE INTERIOR  
BUREAU OF LAND MANAGEMENT  
**MAINTENANCE FEE WAIVER CERTIFICATION**

529  
CME

427452  
430544

FORM APPROVED  
OMB NO. 1004-0114  
Expires: January 31, 2020

SEE INSTRUCTIONS ON PAGE 2

1. This small miner waiver is filed for the assessment year beginning on September 1, 2018 and ending on September 1, 2019.
2. The undersigned and all related parties owned ten or fewer mining claims, mill, or tunnel sites located and maintained on Federal lands in the United States of America on September 1, 2019.
3. The undersigned have performed the assessment work required by law for each mining claim listed prior to filing this waiver and understand that by filing this form, the undersigned must file an affidavit of assessment work with the Bureau of Land Management (BLM) by the December 30th following the filing of this waiver.
4. The undersigned understand that if the assessment work obligation has not yet come due under 30 U.S.C. 28 (for those claims in their first assessment year only), a notice of intent to hold reciting this condition must be recorded by the December 30th following the filing of this waiver.
5. The undersigned understand that mill and tunnel sites may also be listed on this waiver and be waived from payment of the maintenance fee, and that a notice of intent to hold for these sites is required to be filed with the BLM by the December 30th following the filing of this waiver.
6. The undersigned understand and acknowledge that pursuant to 43 U.S.C. 1212 and 18 U.S.C. 1001, the filing or recording of a false, fictitious, or fraudulent document with the BLM may result in a fine of up to \$250,000, a prison term not to exceed five years, or both.
7. The mining claims, mill or tunnel sites for which this waiver from payment of the maintenance fees is requested are:

CLAIM OR SITE NAME	BLM RECORDATION SERIAL NUMBER
1. MAVERICK	427452 (913)
2. MAVERICK-2	430544
3. MAVERICK-3	430545 (430544)
4. MAVERICK-4	430546
5. MAVERICK-5	430547
6. MAVERICK-6	430548
7. MAVERICK-7	430549
8.	
9.	
10.	

RECEIVED  
BLM AT STATE OFFICE  
2018 AUG 31 A 11:19  
PHOENIX, ARIZONA

The owner(s) (claimants) of the above mining claims and sites are:

Christopher A Miller  
(Owner's Name - Please Print)

16170 WEST Dynamite RIVD  
(Owner's Mailing Address)

*Christopher A Miller*  
(Owner's Signature)

Surprise AZ 85387  
(City) (State) (Zip Code)

(Owner's Name - Please Print)

(Owner's Signature)

(Owner's Mailing Address)

(City)

(State)

(Zip Code)

(Owner's Name - Please Print)

(Owner's Signature)

(Owner's Mailing Address)

(City)

(State)

(Zip Code)

(Owner's Name - Please Print)

(Owner's Signature)

(Owner's Mailing Address)

(City)

(State)

(Zip Code)

(Continued on page 2)

ENTERED  
SEP 11 2018  
BY: BPS



427452  
430544  
442436

When Recorded Return Document to:

Christopher A Miller

16170 West Dynamite BLVD

Surprise AZ 85378

Check here if this is a change of address.

Telephone: 623-687-6538

E-mail address: \_\_\_\_\_

**AFFIDAVIT OF PERFORMANCE OF ANNUAL WORK**

1. State of Arizona, County of Yavapia ss:

2. I (Name) Christopher A Miller

3. Reside at (Address) 16170 West Dynamite BLVD

City Surprise County Maricopa

State AZ Zip 85378 being duly sworn, depose and say that I am a citizen of the United States, more than eighteen years of age, and that all of the facts set forth in this affidavit, subject to the provisions and penalties of 18 U.S.C. 1001 pertaining to the filing of false, fictitious, or fraudulent statements with the United States, are true and correct according to the best of my knowledge, information and belief.

4. Owner's name and address (If not shown in Items 1-3 above). \_\_\_\_\_

5. That I am personally acquainted with the mining claim(s). The work and improvements were made by and at the expense of the owner(s) of said claim(s). Said contiguous group of claims, listed on this document, are situated in the

\_\_\_\_\_ (optional) Mining District; Yavapia County, Arizona.

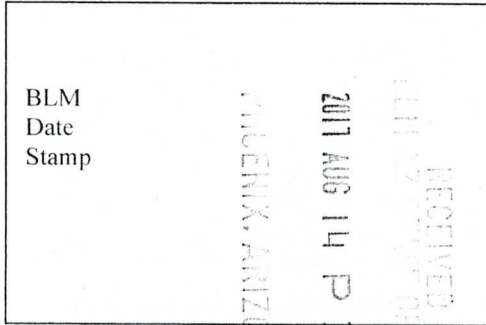

Line No.	AMC NUMBER	CLAIM/SITE NAME	COUNTY RECORDER DATA (If available)	TWP	RNG	SEC
1	427452	Maverick		11N	1E	26
2	430544	Maverick-2		11N	1E	26
3	430545	Maverick-3		11N	1E	26
4	430546	Maverick-4		11N	1E	26
5	430547	Maverick-5		11N	1E	26
6	430548	Maverick-6		11N	1E	26

Form: MCF108

Revised July 2014

Page 1 of 2

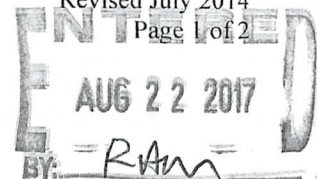

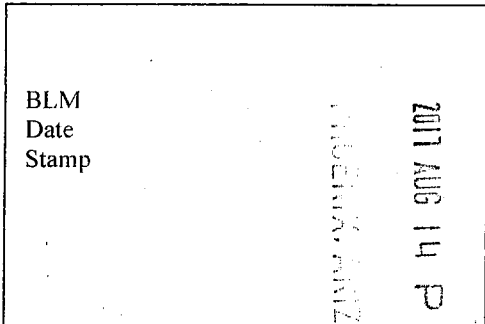

7	430549	Maverick-7		11N	1E	24
8	442436	No Choice 2		12.5N	2W	30
9						
10						

6. That between the dates starting at 12 o'clock noon on September 1, 20 16 and ending at 12 o'clock noon on September 1, 20 17 at least \$ 100.00 dollars worth of work and improvements were done and performed upon said claim(s) or upon one or more of a contiguous group of claims for the benefit of all, wholly or partly outside of a contiguous group of claims for the benefit of all, not including the location work.

7. That the following persons were employed to perform the work and improvements described herein: \_\_\_\_\_  
Christopher A Miller

8. That the work and improvements performed were: Maintaining Monument and Corner Post, Mining,  
Prospecting, Trash Removal

9. Dated: 8/11/2017 Signature: [Handwritten Signature]

SUBSCRIBED AND SWORN TO before me, a Notary Public, this 11<sup>th</sup> day of August 20 17

By: Christopher A. Miller

Notary Public Gerrick S. Garrett

My Commission Expires April 20, 2018

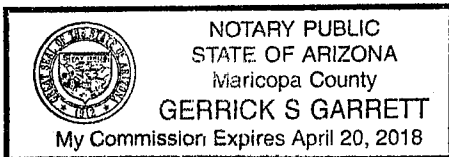

Bureau of Land Management  
 Arizona State Office  
[www.blm.gov/az](http://www.blm.gov/az)

No. of Claims: 8 x \$10 = \$80.00  
 Check No.: 1088 Init. [Handwritten Initials]  
 Receipt No.: 3937864  
 For BLM Use Only

**NOTICE OF INTENTION TO HOLD MINING CLAIMS/SITES**

When Recorded Return Document to:

Christopher A Miller

16170 West Dynmaite BLVD

Surprise AZ 85387

BLM  
Date  
Stamp

BLM RECEIVED  
2017 AUG 14 P 3:11  
PHOENIX, ARIZONA

Check here if this is a change of address.

Telephone: 623-687-6538

E-mail Address: \_\_\_\_\_

I (We) intend to hold the claims(s) and/or site(s) listed below for the calendar year 20\_\_\_\_, and I (We) have filed or will file a Notice of Intent to Hold in the county where the claim (s) is located.

Reason for filing a Notice of Intent to Hold instead of an assessment work filing (check one):

- Maintenance fee was paid to maintain claim(s) during this assessment year.
- Mill or tunnel sites.
- Claim(s) was located during the current assessment year.
- BLM has deferred assessment work (attach copy of decision granting deferment, or pending petition for deferment including date petition was filed.)

Line No.	AMC NUMBER	CLAIM/SITE NAME	COUNTY RECORDER DATA (If available)	TWP	RNG	SEC
1	427452	Maverick		11N	1E	26
2	430544	Maverick-2		11N	1E	26
3	430545	Maverick-3		11N	1E	26
4	430546	Maverick-4		11N	1E	26
5	430547	Maverick-5		11N	1E	26
6	430548	Maverick-6		11N	1E	26
7	430549	Maverick-7		11N	1E	26
8	442436	No Choice 2		12.5N	2W	30
9						
10						



NOTICE OF INTENTION TO HOLD MINING CLAIMS/SITES  
page 2

BLM  
Date  
Stamp

RECEIVED  
2017 AUG 14 PM 3:11  
BLM ARIZONA

1. State of Arizona, County of Yavapia  
2. I (Name) Christopher A Miller  
3. Reside at (Address) 16170 West Dynamite BLVD

City Surprise County Maricopa State AZ Zip 85387 being duly sworn, depose and say that I am a citizen of the United States, more than eighteen years of age, that all of the facts set forth in this notice, subject to the provisions and penalties of 18 U.S.C. 1001 pertaining to the filing of false, fictitious, or fraudulent statements with the United States, are true and correct according to the best of my knowledge, information and belief.

4. Owner's name and address (If not shown in Items 1-3 above). \_\_\_\_\_

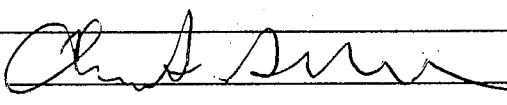
5. Dated: 8/11/2017 Signature: 

Bureau of Land Management  
Arizona State Office  
[www.blm.gov/az](http://www.blm.gov/az)

No. of Claims: 8 x \$10 = \$80.00  
Check No: 1089 Init. \_\_\_\_\_  
Receipt No.: \_\_\_\_\_  
For BLM Use Only

Christopher A Miller  
16170 West Dynamite BLVD  
Surprise AZ 85387

  
Bureau of Land Management  
Arizona State Office  
1 North Central Avenue, Suite 800  
Phoenix AZ 85004-4427

RECEIVED  
BLM AZ STATE OFFICE  
2017 AUG 14 P 3:09  
PHOENIX, ARIZONA

\$0.670  
US POSTAGE  
FIRST-CLASS  
AZ 85387  
2017



062S0009223367

**United States Department of the Interior**  
**Bureau of Land Management**  
 DIV OF LANDS, MINRLS & ENERGY  
 ONE N CENTRAL AVE  
 PHOENIX, AZ 85004 -4427  
 Phone: 602-417-9200

Receipt

No: 3937864

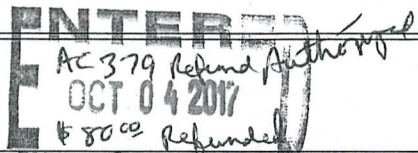
<b>Transaction #:</b> 4047481	
<b>Date of Transaction:</b> 08/15/2017	
CUSTOMER:	
CHRISTOPHER MILLER 16170 W DYNAMITE BLVD SURPRISE, AZ 85387-6704 US	

LINE #	QTY	DESCRIPTION	REMARKS	UNIT PRICE	TOTAL
1	1.00	LOCATABLE MINERALS / MINING CLAIMS-NOT NEW-UNADJUD, ONE AUTH NO. ONLY / MINING CLAIM MONEY RECEIVED <b>CASES: AMC427452/\$240.00</b>	POL 2017/8 NOI 2017/8 MAINT 2018/8 <i>NAV</i>	- n/a -	240.00
<b>TOTAL:</b>					<b>\$240.00</b>

PAYMENT INFORMATION			
1	AMOUNT:	80.00	POSTMARKED: 08/11/2017
	TYPE:	CHECK	RECEIVED: 08/14/2017
	CHECK NO:	1088	
	NAME:	MILLER, CHRISTOPHER A 16170 W DYNAMITE BLVD SURPRISE AZ 85387-6704 US	
2	AMOUNT:	80.00	POSTMARKED: 08/11/2017
	TYPE:	CHECK	RECEIVED: 08/14/2017
	CHECK NO:	1089	
	NAME:	MILLER, CHRISTOPHER A 16170 W DYNAMITE BLVD SURPRISE AZ 85387-6704 US	
3	AMOUNT:	80.00	POSTMARKED: 08/11/2017
	TYPE:	CHECK	RECEIVED: 08/14/2017
	CHECK NO:	1090	
	NAME:	MILLER, CHRISTOPHER A 16170 W DYNAMITE BLVD SURPRISE AZ 85387-6704 US	



AMC427452

**Authorized Date**10/04/2017

**Instructions to Accounts**AZ BLM REFUND \$80 TO CHRISTOPHER MILLER; FOR  
OVERPAYMENT OF POL/NOI FEES PAID, ON AMC427452,  
RECEIPT #3937864. PB 602-417-9360.

**Login ID**5957

**Entry Date**10/04/2017

**Total Amount**\$80.00

**DEPARTMENT OF THE INTERIOR  
BUREAU OF LAND MANAGEMENT  
MINING CLAIMS**

Run Date/Time: 10/04/2017 03:03 PM

**(LIVE) Serial Register Page**

Page 1 of 1

01 10-21-1976;090STAT0090;43USC1744  
Case Type 384201: PLACER CLAIM  
Claim Name: MAVERICK  
Commodity :  
Case Disposition: ACTIVE  
Required Maintenance Fee: \$155.00

Total Acres  
20.000

Serial Number  
AMC427452  
Lead File Number  
AMC427452

Name & Address	Int Rel
MILLER CHRISTOPHER A 16170 W DYNAMITE BLVD SURPRISE, AZ 85387-6704	CLAIMANT

Mer Twp Rng Sec	Quadrant	District/Field Office	County
14 0110N 0010E 026	NW	HASSAYAMPA FO	YAVAPAI

Act Date	Code	Action	Action Remarks	Receipt Number
03/01/2014	403	LOCATION DATE		
03/07/2014	395	RECORDATION NOTICE RECD	1	2985359
08/14/2017	483	SMALL MINER CERT FILED	2018	
08/14/2017	480	EVID OF ASSMT FILED	2017	3937864
08/14/2017	481	NOTICE OF INTENT TO HOLD	2017	3937864
08/26/2016	483	SMALL MINER CERT FILED	2017	
08/26/2016	480	EVID OF ASSMT FILED	2016	3644761
08/26/2016	481	NOTICE OF INTENT TO HOLD	2016	3644761
08/18/2015	483	SMALL MINER CERT FILED	2016	
08/18/2015	480	EVID OF ASSMT FILED	2015	3370660
08/18/2015	481	NOTICE OF INTENT TO HOLD	2015	3370660
08/08/2014	483	SMALL MINER CERT FILED	2015	
03/07/2014	484	LOCATION YEAR / MAINTENANCE	2014;\$140	2985359
08/08/2014	480	EVID OF ASSMT FILED	2014	3097816
08/08/2014	481	NOTICE OF INTENT TO HOLD	2014	3097816
10/04/2017	379	REFUND AUTHORIZED	\$80;OVERPAYMENT	3937864
08/14/2017	392	MONIES RECEIVED	\$80.00;1	3937864
10/04/2016	379	REFUND AUTHORIZED	\$70;OVERPAYMENT	3644761
09/14/2015	379	REFUND AUTHORIZED	\$10;OVERPAYMENT	3370660
06/26/2014	669	LAND STATUS CHECKED		
03/07/2014	501	ACCT ADV IN LEAD FILE	AMC427452;	

Line Nr Remarks

**NO WARRANTY IS MADE BY BLM  
FOR USE OF THE DATA FOR  
PURPOSES NOT INTENDED BY BLM**

1

157  
JMC

AMC 427452  
430544  
442436

Form 3830-2  
(January 2017)

UNITED STATES  
DEPARTMENT OF THE INTERIOR  
BUREAU OF LAND MANAGEMENT  
**MAINTENANCE FEE WAIVER CERTIFICATION**

FORM APPROVED  
OMB NO. 1004-0114  
Expires: January 31, 2020

SEE INSTRUCTIONS ON PAGE 2

- This small miner waiver is filed for the assessment year beginning on September 1, ~~2016~~<sup>2017</sup> and ending on September 1, ~~2017~~<sup>2018</sup>.
- The undersigned and all related parties owned ten or fewer mining claims, mill, or tunnel sites located and maintained on Federal lands in the United States of America on September 1, 2017.
- The undersigned have performed the assessment work required by law for each mining claim listed prior to filing this waiver and understand that by filing this form, the undersigned must file an affidavit of assessment work with the Bureau of Land Management (BLM) by the December 30th following the filing of this waiver.
- The undersigned understand that if the assessment work obligation has not yet come due under 30 U.S.C. 28 (for those claims in their first assessment year only), a notice of intent to hold reciting this condition must be recorded by the December 30th following the filing of this waiver.
- The undersigned understand that mill and tunnel sites may also be listed on this waiver and be waived from payment of the maintenance fee, and that a notice of intent to hold for these sites is required to be filed with the BLM by the December 30th following the filing of this waiver.
- The undersigned understand and acknowledge that pursuant to 43 U.S.C. 1212 and 18 U.S.C. 1001, the filing or recording of a false, fictitious, or fraudulent document with the BLM may result in a fine of up to \$250,000, a prison term not to exceed five years, or both.
- The mining claims, mill or tunnel sites for which this waiver from payment of the maintenance fees is requested are:

CLAIM OR SITE NAME	BLM RECORDATION SERIAL NUMBER
1. Maverick	✓ 427452
2. Maverick-2	430544
3. Maverick-3	430545
4. Maverick-4	430546
5. Maverick-5	430547
6. Maverick-6	430548
7. Maverick-7	430549
8. No Choice 2	442436
9.	
10.	

The owner(s) (claimants) of the above mining claims and sites are:

Christopher A Miller  
(Owner's Name - Please Print)

*Christopher A Miller*  
(Owner's Signature)

16170 West DynamiteBLVD  
(Owner's Mailing Address)

Surprise AZ 85387  
(City) (State) (Zip Code)

(Owner's Name - Please Print)

(Owner's Signature)

(Owner's Mailing Address)

(City) (State) (Zip Code)

(Owner's Name - Please Print)

(Owner's Signature)

(Owner's Mailing Address)

(City) (State) (Zip Code)

(Owner's Name - Please Print)

(Owner's Signature)

(Owner's Mailing Address)

(City) (State) (Zip Code)

(Continued on page 2)

483  
ENTERED  
AUG 31 2017  
BY: *JMC*

PHOENIX, ARIZONA  
2017 AUG 16 P 3:10  
RECEIVED  
BLM AZ STATE OFFICE

*nwl  
pm*



UNITED STATES  
DEPARTMENT OF THE INTERIOR  
BUREAU OF LAND MANAGEMENT

484

MAINTENANCE FEE WAIVER CERTIFICATION

FORM APPROVED  
OMB NO. 1004-0114  
Expires: October 31, 2016

427452 430544

SEE INSTRUCTIONS ON PAGE 2

1. This small miner waiver is filed for the assessment year beginning on September 1, 2015 and ending on September 1, 2016.
2. The undersigned and all related parties owned ten or fewer mining claims, mill, or tunnel sites located and maintained on Federal lands in the United States of America on September 1, 2016.
3. The undersigned have performed the assessment work required by law for each mining claim listed prior to filing this waiver and understand that by filing this form, the undersigned must file an affidavit of assessment work with the Bureau of Land Management (BLM) by the December 30th following the filing of this waiver.
4. The undersigned understand that if the assessment work obligation has not yet come due under 30 U.S.C. 28 (for those claims in their first assessment year only), a notice of intent to hold reciting this condition must be recorded by the December 30th following the filing of this waiver.
5. The undersigned understand that mill and tunnel sites may also be listed on this waiver and be waived from payment of the maintenance fee, and that a notice of intent to hold for these sites is required to be filed with the BLM by the December 30th following the filing of this waiver.
6. The undersigned understand and acknowledge that pursuant to 43 U.S.C. 1212 and 18 U.S.C. 1001, the filing or recording of a false, fictitious, or fraudulent document with the BLM may result in a fine of up to \$250,000, a prison term not to exceed five years, or both.
7. The mining claims, mill or tunnel sites for which this waiver from payment of the maintenance fees is requested are:

CLAIM OR SITE NAME	BLM RECORDATION SERIAL NUMBER
1. Maverick	427452 ✓
2. Maverick-2	430544
3. Maverick-3	430545
4. Maverick-4	430546
5. Maverick-5	430547
6. Maverick-6	430548
7. Maverick-7	430549
8.	
9.	
10.	

RECEIVED  
BLM AZ STATE OFFICE  
2016 AUG 26 P 1:59  
PHOENIX, ARIZONA

The owner(s) (claimants) of the above mining claims and sites are:

Christopher A Miller

(Owner's Name - Please Print)

(Owner's Signature)

16170 West Dynamtie BLVD

(Owner's Mailing Address)

Surprise

(City)

AZ

(State)

85387

(Zip Code)

(Owner's Name - Please Print)

(Owner's Signature)

(Owner's Mailing Address)

(City)

(State)

(Zip Code)

(Owner's Name - Please Print)

(Owner's Signature)

(Owner's Mailing Address)

(City)

(State)

(Zip Code)

(Owner's Name - Please Print)

(Owner's Signature)

(Owner's Mailing Address)

(City)

(State)

(Zip Code)

(Continued on page 2)

ENTERED  
483  
SEP 08 2013  
BY:

LUCIFER WHISKEY

TOP WINE SP B 1:24

BOTTLE RECEIVED



Bureau of Land Management  
Arizona State Office  
One North Central Avenue, Suite 800  
Phoenix, AZ 85004-4427

430544  
427452  
RECEIVED  
BLM AZ STATE OFFICE  
2016 AUG 26 P 1:58  
PHOENIX, ARIZONA

Please contact with me if any clerical errors or any other concerns.

Thank You

Christopher A Miller

623-687-6538

A handwritten signature in black ink that reads "Chris A Miller". The signature is written in a cursive, flowing style.



**MAINTENANCE FEE PAYMENT**

Claimant Name: Christopher A Miller  
 Address: 16170 West Dynamite BLVD  
 City: Surprise State: AZ Zip: 85378  
 Telephone: 623-687-6538  
 E-mail address: \_\_\_\_\_  
 Signature: \_\_\_\_\_

RECEIVED  
 BLM AZ STATE OFFICE  
 2016 AUG 26 P 1:58  
 PHOENIX, ARIZONA  
 BLM  
 Date  
 Stamp

Check here if this is a change of address.

LINE NO.	AMC NUMBER	CLAIM/SITE NAME	COUNTY RECORDER DATA (If available)	TWP	RNG	SEC
1	427452	Maverick		11N	1E	26
2	430544	Maverick-2		11N	1E	26
3	430545	Maverick-3		11N	1E	26
4	430546	Maverick-4		11N	1E	26
5	430547	Maverick-5		11N	1E	26
6	430548	Maverick-6		11N	1E	26
7	430549	Maverick-7		11N	1E	24
8						
9		Please See Attached Waiver				
10						

List additional claims on Form MCF114.

**Bureau of Land Management**  
**Arizona State Office**  
[www.blm.gov/az/](http://www.blm.gov/az/)

No. of Claims*: <u>7</u> x <sup>\$10.00</sup> \$155 = <u>70.00</u>
Check No: <u>1009</u> Init. <u>A.M.</u>
Receipt No.: <u>3044760</u>
For BLM Use Only

\* \$155 per lode mining claim, mill site, or tunnel site; and \$155 for each 20 acres or portion thereof for each placer mining claim.

Form: MCF112  
 Revised July 2014



When Recorded Return Document to:  
Christopher A Miller

16170 West Dynamtie BLVD

Surprise AZ 85378

Check here is this is a change of address.

Telephone: 623-687-6538

E-mail address: \_\_\_\_\_

### AFFIDAVIT OF PERFORMANCE OF ANNUAL WORK

1. State of Arizona, County of Yavapia ss:

2. I (Name) Christopher A Miller

3. Reside at (Address) 16170 West Dynamite BLVD

City Surprise County Maricopa

State AZ Zip 85378 being duly sworn, depose and say that I am a citizen of the United States, more than eighteen years of age, and that all of the facts set forth in this affidavit, subject to the provisions and penalties of 18 U.S.C. 1001 pertaining to the filing of false, fictitious, or fraudulent statements with the United States, are true and correct according to the best of my knowledge, information and belief.

4. Owner's name and address (If not shown in Items 1-3 above). \_\_\_\_\_

5. That I am personally acquainted with the mining claim(s). The work and improvements were made by and at the expense of the owner(s) of said claim(s). Said contiguous group of claims, listed on this document, are situated in the

(optional) Mining District; Yavapia County, Arizona.

Line No.	AMC NUMBER	CLAIM/SITE NAME	COUNTY RECORDER DATA (If available)	TWP	RNG	SEC
1	427452	Maverick		11N	1E	26
2	430544	Maverick-2		11N	1E	26
3	430545	Maverick-3		11N	1E	26
4	430546	Maverick-4		11N	1E	26
5	430547	Maverick-5		11N	1E	26
6	430548	Maverick-6		11N	1E	26

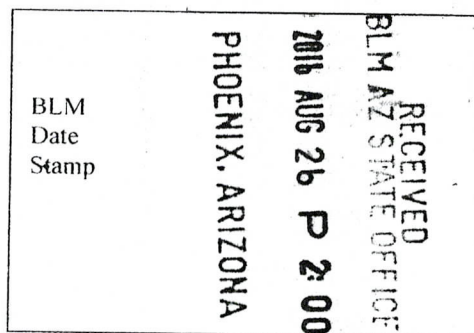



RECEIVED  
BLM AZ STATE OFFICE  
2016 AUG 26 P 2:00  
PHOENIX, ARIZONA  
BLM  
Date  
Stamp

7	430549	Maverick-7		11N	1E	24
8						
9						
10						

6. That between the dates starting at 12 o'clock noon on September 1, 20 15 and ending at 12 o'clock noon on September 1, 20 16 at least \$ 100.00 dollars worth of work and improvements were done and performed upon said claim(s) or upon one or more of a contiguous group of claims for the benefit of all, wholly or partly outside of a contiguous group of claims for the benefit of all, not including the location work.

7. That the following persons were employed to perform the work and improvements described herein: \_\_\_\_\_  
Christopher A Miller

8. That the work and improvements performed were: Maintining Monutment and Corner Post, Mining,  
Prospecting, Trash Removal

9. Dated: 8/23/2016 Signature: [Signature]

SUBSCRIBED AND SWORN TO before me, a Notary Public, this 23 day of AUG 20 16

By: \_\_\_\_\_  
Notary Public [Signature]  
My Commission Expires 08-26-2019

Bureau of Land Management  
Arizona State Office  
[www.blm.gov/az](http://www.blm.gov/az)

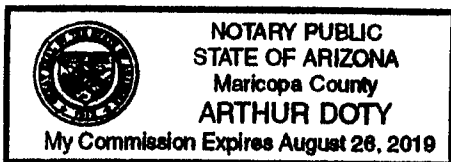

No. of Claims: 7 x \$10 = 70.00  
Check No.: 1007 Init. AD  
Receipt No.: 3044761  
For BLM Use Only

**NOTICE OF INTENTION TO HOLD MINING CLAIMS/SITES**

When Recorded Return Document to:

Christopher A Miller

16170 West Dynamite BLVD

Surprise AZ 85378

Check here if this is a change of address.

Telephone: 623-687-6538

E-mail Address: \_\_\_\_\_

BLM  
Date  
Stamp

PHOENIX, ARIZONA

2016 AUG 26 P 1:59

RECEIVED  
BLM AZ STATE OFFICE

I (We) intend to hold the claims(s) and/or site(s) listed below for the calendar year 2016, and I (We) have filed or will file a Notice of Intent to Hold in the county where the claim (s) is located.

Reason for filing a Notice of Intent to Hold instead of an assessment work filing (check one):

- Maintenance fee was paid to maintain claim(s) during this assessment 1 year.
- Mill or tunnel sites.
- Claim(s) was located during the current assessment year.
- BLM has deferred assessment work (attach copy of decision granting deferment, or pending petition for deferment including date petition was filed.)

Line No.	AMC NUMBER	CLAIM/SITE NAME	COUNTY RECORDER DATA (If available)	TWP	RNG	SEC
1	427452	Maverick		11N	1E	26
2	430544	Maverick-2		11N	1E	26
3	430545	Maverick-3		11N	1E	26
4	430546	Maverick-4		11N	1E	26
5	430547	Maverick-5		11N	1E	26
6	430548	Maverick-6		11N	1E	26
7	430549	Maverick-7		11N	1E	24
8						
9						
10						

NOTICE OF INTENTION TO HOLD MINING CLAIMS/SITES  
page 2

BLM  
Date  
Stamp

RECEIVED  
BLM AZ STATE OFFICE  
2016 AUG 26 P 1:59  
PHOENIX, ARIZONA

1. State of Arizona, County of Yavapia

2. I (Name) Christopher A Miller

3. Reside at (Address) 16170 West Dynamite BLVD

City Surprise County Maricopa State AZ Zip 85378 being duly sworn, depose and say that I am a citizen of the United States, more than eighteen years of age, that all of the facts set forth in this notice, subject to the provisions and penalties of 18 U.S.C. 1001 pertaining to the filing of false, fictitious, or fraudulent statements with the United States, are true and correct according to the best of my knowledge, information and belief.

4. Owner's name and address (If not shown in Items 1-3 above). \_\_\_\_\_

5. Dated: 8/23/2016 Signature: *Chris A Miller*

Bureau of Land Management  
Arizona State Office  
[www.blm.gov/az](http://www.blm.gov/az)

No. of Claims: 7 x \$10 = 70.00  
Check No: 1008 Init. *AM*  
Receipt No.: 3644761  
For BLM Use Only



**United States Department of the Interior**  
**Bureau of Land Management**  
 LANDS/RECREATION & PLANNING  
 ONE N CENTRAL AVE  
 PHOENIX, AZ 85004 -2203  
 Phone: 602-417-9200

Receipt

No: 3370284

<b>Transaction #:</b> 3468438	
<b>Date of Transaction:</b> 08/18/2015	
<b>CUSTOMER:</b>	
CHRISTOPHER MILLER 16170 W DYNAMITE BLVD SURPRISE, AZ 85387-6704 US	

LINE #	QTY	DESCRIPTION	REMARKS	UNIT PRICE	TOTAL
1	1.00	LOCATABLE MINERALS / MINING CLAIMS-NOT NEW-UNADJUD, ONE AUTH NO. ONLY / MINING CLAIM MONEY RECEIVED CASES: AMC430544/\$60.00	MAINT FEE WAIVER (6) 2016 / POL (6) 2015	- n/a -	60.00
2	1.00	LOCATABLE MINERALS / MINING CLAIMS-NOT NEW-UNADJUD, ONE AUTH NO. ONLY / MINING CLAIM MONEY RECEIVED CASES: AMC430544/\$60.00	NOI (6) 2015	- n/a -	60.00
3	1.00	LOCATABLE MINERALS / MINING CLAIMS-NOT NEW-UNADJUD, ONE AUTH NO. ONLY / MINING CLAIM MONEY RECEIVED CASES: AMC430544/\$60.00	POL (6) 2015	- n/a -	60.00
<b>TOTAL:</b>					<b>\$180.00</b>

PAYMENT INFORMATION			
1	AMOUNT:	60.00	POSTMARKED: N/A
	TYPE:	CHECK	RECEIVED: 08/17/2015
	CHECK NO:	1236	
	NAME:	MILLER, CHRISTOPHER 16170 W DYNAMITE BLVD SURPRISE AZ 85387-6704 US	
2	AMOUNT:	60.00	POSTMARKED: N/A
	TYPE:	CHECK	RECEIVED: 08/17/2015
	CHECK NO:	1237	

	NAME:	MILLER, CHRISTOPHER 16170 W DYNAMITE BLVD SURPRISE AZ 85387-6704 US	
3	AMOUNT:	60.00	POSTMARKED: N/A
	TYPE:	CHECK	RECEIVED: 08/17/2015
	CHECK NO:	1238	
	NAME:	MILLER, CHRISTOPHER 16170 W DYNAMITE BLVD SURPRISE AZ 85387-6704 US	

REMARKS

This receipt was generated by the automated BLM Collections and Billing System and is a paper representation of a portion of the official electronic record contained therein.

**RECEIVED**  
**BLM AZ STATE OFFICE**  
**2016 AUG 26 P 2:00**  
**PHOENIX, ARIZONA**

2016 AUG 26 P 2:01

United States Department of the Interior  
Bureau of Land Management PHOENIX, ARIZONA Receipt  
LANDS/RECREATION & PLANNING  
ONE N CENTRAL AVE  
PHOENIX, AZ 85004 -2203 No: 3370660  
Phone: 602-417-9200

<b>Transaction #:</b> 3468820	
<b>Date of Transaction:</b> 08/19/2015	
<b>CUSTOMER:</b>	
CHRISTOPHER MILLER 16170 W DYNAMITE BLVD SURPRISE, AZ 85387-6704 US	

LINE #	QTY	DESCRIPTION	REMARKS	UNIT PRICE	TOTAL
1	1.00	LOCATABLE MINERALS / MINING CLAIMS-NOT NEW-UNADJUD, ONE AUTH NO. ONLY / MINING CLAIM MONEY RECEIVED CASES: AMC427452/\$10.00	MAINT FEE PYMNT (1) 2016 / POL (1) 2015	- n/a -	10.00
2	1.00	LOCATABLE MINERALS / MINING CLAIMS-NOT NEW-UNADJUD, ONE AUTH NO. ONLY / MINING CLAIM MONEY RECEIVED CASES: AMC427452/\$10.00	NOI (1) 2015	- n/a -	10.00
3	1.00	LOCATABLE MINERALS / MINING CLAIMS-NOT NEW-UNADJUD, ONE AUTH NO. ONLY / MINING CLAIM MONEY RECEIVED CASES: AMC427452/\$10.00	POL (1) 2015	- n/a -	10.00
<b>TOTAL:</b>					<b>\$30.00</b>

PAYMENT INFORMATION			
1	AMOUNT:	10.00	POSTMARKED: N/A
	TYPE:	CHECK	RECEIVED: 08/18/2015
	CHECK NO:	1181	
	NAME:	MILLER, CHRISTOPHER 16170 W DYNAMITE BLVD SURPRISE AZ 85387-6704 US	
2	AMOUNT:	10.00	POSTMARKED: N/A
	TYPE:	CHECK	RECEIVED: 08/18/2015
	CHECK NO:	1239	



	NAME:	MILLER, CHRISTOPHER 16170 W DYNAMITE BLVD SURPRISE AZ 85387-6704 US	
3	AMOUNT:	10.00	POSTMARKED: N/A
	TYPE:	CHECK	RECEIVED: 08/18/2015
	CHECK NO:	1240	
	NAME:	MILLER, CHRISTOPHER 16170 W DYNAMITE BLVD SURPRISE AZ 85387-6704 US	

REMARKS

This receipt was generated by the automated BLM Collections and Billing System and is a paper representation of a portion of the official electronic record contained therein.

RECEIVED  
 BLM AZ STATE OFFICE  
 2015 AUG 26 P 2:01  
 PHOENIX, ARIZONA

**United States Department of the Interior**  
**Bureau of Land Management**  
 DIV OF LANDS, MINRLS & ENERGY  
 ONE N CENTRAL AVE  
 PHOENIX, AZ 85004 -4427  
 Phone: 602-417-9200

Receipt

No: 3644761

<b>Transaction #:</b> 3748735	
<b>Date of Transaction:</b> 08/29/2016	
<b>CUSTOMER:</b>	
CHRISTOPHER MILLER 16170 W DYNAMITE BLVD SURPRISE, AZ 85387-6704 US	

LINE #	QTY	DESCRIPTION	REMARKS	UNIT PRICE	TOTAL
1	1.00	LOCATABLE MINERALS / MINING CLAIMS-NOT NEW- UNADJUD, ONE AUTH NO. ONLY / MINING CLAIM MONEY RECEIVED <b>CASES:</b> AMC427452/\$70.00	WAIVER 2017 - 7 / MAINT FEE 2017 - 7 / SUPPLEMENTAL ATTACHMENT	- n/a -	70.00
2	1.00	LOCATABLE MINERALS / MINING CLAIMS-NOT NEW- UNADJUD, ONE AUTH NO. ONLY / MINING CLAIM MONEY RECEIVED <b>CASES:</b> AMC427452/\$70.00	POL 2016 - 7	- n/a -	70.00
3	1.00	LOCATABLE MINERALS / MINING CLAIMS-NOT NEW- UNADJUD, ONE AUTH NO. ONLY / MINING CLAIM MONEY RECEIVED <b>CASES:</b> AMC427452/\$70.00	NOI 2016 - 7	- n/a -	70.00
<b>TOTAL:</b>					<b>\$210.00</b>

*REFUND  
4 OCT 16  
[Signature]*

PAYMENT INFORMATION			
1	AMOUNT:	70.00	POSTMARKED: 08/23/2016
	TYPE:	CHECK	RECEIVED: 08/26/2016
	CHECK NO:	1007	
	NAME:	MILLER, CHRISTOPHER A 16170 W DYNAMITE BLVD SURPRISE AZ 85387-6704 US	
2	AMOUNT:	70.00	POSTMARKED: 08/23/2016

	TYPE:	CHECK	RECEIVED:	08/26/2016
	CHECK NO:	1008		
	NAME:	MILLER, CHRISTOPHER A 16170 W DYNAMITE BLVD SURPRISE AZ 85387-6704 US		
3	AMOUNT:	70.00	POSTMARKED:	08/23/2016
	TYPE:	CHECK	RECEIVED:	08/26/2016
	CHECK NO:	1009		
	NAME:	MILLER, CHRISTOPHER A 16170 W DYNAMITE BLVD SURPRISE AZ 85387-6704 US		

REMARKS

This receipt was generated by the automated BLM Collections and Billing System and is a paper representation of a portion of the official electronic record contained therein.

**ENTERED**  
 AUG 31 2016  
 BY: \_\_\_\_\_



**Authorized Date** 10/04/2016

**Instructions to Accounts** AZ BLM REFUND TO CHRISTOPHER MILLER \$70.00 FOR  
OVERPAYMENT ON AMC427452 RECEIPT #3644761. IO

**Login ID** 7196

**Entry Date** 10/04/2016

**Total Amount** \$70.00

UNITED STATES  
DEPARTMENT OF THE INTERIOR  
BUREAU OF LAND MANAGEMENT

308

AMC 430544

MAINTENANCE FEE WAIVER CERTIFICATION

FORM APPROVED  
OMB NO. 1004-0114  
Expires: October 31, 2016

SEE INSTRUCTIONS ON PAGE 2

1. This small miner waiver is filed for the assessment year beginning on September 1, 2015 and ending on September 1, 2016.
2. The undersigned and all related parties owned ten or fewer mining claims, mill, or tunnel sites located and maintained on Federal lands in the United States of America on September 1, 2015.
3. The undersigned have performed the assessment work required by law for each mining claim listed prior to filing this waiver and understand that by filing this form, the undersigned must file an affidavit of assessment work with the Bureau of Land Management (BLM) by the December 30th following the filing of this waiver.
4. The undersigned understand that if the assessment work obligation has not yet come due under 30 U.S.C. 28 (for those claims in their first assessment year only), a notice of intent to hold reciting this condition must be recorded by the December 30th following the filing of this waiver.
5. The undersigned understand that mill and tunnel sites may also be listed on this waiver and be waived from payment of the maintenance fee, and that a notice of intent to hold for these sites is required to be filed with the BLM by the December 30th following the filing of this waiver.
6. The undersigned understand and acknowledge that pursuant to 43 U.S.C. 1212 and 18 U.S.C. 1001, the filing or recording of a false, fictitious, or fraudulent document with the BLM may result in a fine of up to \$250,000, a prison term not to exceed five years, or both.
7. The mining claims, mill or tunnel sites for which this waiver from payment of the maintenance fees is requested are:

CLAIM OR SITE NAME	BLM RECORDATION SERIAL NUMBER
1. MAVERICK - 2	AMC 430544 ✓
2. MAVERICK - 3	AMC 430545
3. MAVERICK - 4	AMC 430546
4. MAVERICK - 5	AMC 430547
5. MAVERICK - 6	AMC 43548
6. MAVERICK - 7	AMC 430549
7.	
8.	
9.	
10.	

The owner(s) (claimants) of the above mining claims and sites are:

Christopher A. Miller

(Owner's Name - Please Print)

16170 W Dynamite Blvd

(Owner's Mailing Address)

(Owner's Signature)

Surprise

(City)

AZ

(State)

85387

(Zip Code)

(Owner's Name - Please Print)

(Owner's Signature)

(Owner's Mailing Address)

(City)

(State)

(Zip Code)

(Owner's Name - Please Print)

(Owner's Signature)

(Owner's Mailing Address)

(City)

(State)

(Zip Code)

(Owner's Name - Please Print)

(Owner's Signature)

(Owner's Mailing Address)

(City)

(State)

(Zip Code)

(Continued on page 2)

PHOENIX, ARIZONA

2015 AUG 17 P 2:49

RECEIVED  
BLM AZ STATE OFFICE

ENTERED  
BY: RE

NW-RE 9/9/15

\_\_\_\_\_  
(Owner's Name - Please Print)

\_\_\_\_\_  
(Owner's Signature)

\_\_\_\_\_  
(Owner's Mailing Address)

\_\_\_\_\_  
(City)

\_\_\_\_\_  
(State)

\_\_\_\_\_  
(Zip Code)

\_\_\_\_\_  
(Owner's Name - Please Print)

\_\_\_\_\_  
(Owner's Signature)

\_\_\_\_\_  
(Owner's Mailing Address)

\_\_\_\_\_  
(City)

\_\_\_\_\_  
(State)

\_\_\_\_\_  
(Zip Code)

\_\_\_\_\_  
(Owner's Name - Please Print)

\_\_\_\_\_  
(Owner's Signature)

\_\_\_\_\_  
(Owner's Mailing Address)

\_\_\_\_\_  
(City)

\_\_\_\_\_  
(State)

\_\_\_\_\_  
(Zip Code)

\_\_\_\_\_  
(Owner's Name - Please Print)

\_\_\_\_\_  
(Owner's Signature)

\_\_\_\_\_  
(Owner's Mailing Address)

\_\_\_\_\_  
(City)

\_\_\_\_\_  
(State)

\_\_\_\_\_  
(Zip Code)

18 U.S.C. 1001 and 43 U.S.C. 1212 make it a crime for any person knowingly and willfully to make to any department or agency of the United States any false, fictitious or fraudulent statements or representations as to any matter within its jurisdiction.

INSTRUCTIONS

1. This certification is made under the provisions of 43 U.S.C. § 1744 and 30 U.S.C. §28-28k and the regulations thereunder (43 CFR Part 3830).
2. The claimant(s) must fill in the dates in paragraph 1 for the beginning and ending of the assessment year for which this waiver is sought.
3. The claimant(s) must fill in the date in paragraph 2 for the beginning of the assessment year for which this waiver is sought.
4. All claim and site names and BLM serial numbers must be listed for the mining claims, mill sites, and tunnel sites for which the waiver is sought.
5. All owners of the mining claims, mill sites, and tunnel sites and their addresses must be given.
6. This waiver form must be signed by all the claimants or their designated agent, in original form. If an agent is designated, a notarized designation of agent, signed by all of the claimants with proper address given, must be submitted with this waiver.
7. This form must be filed no later than September 1st for the upcoming assessment year in the BLM State Office where the mining claims or sites are recorded, or the waiver cannot be granted by the BLM. (Example: To obtain a waiver for the assessment year 2012, which begins on September 1, 2011, you must qualify for and file for a waiver no later than September 1, 2011, in the proper BLM State Office.)
8. For all mining claims which require assessment work, you must record an affidavit of labor on or before the December 30th immediately following the filing of this waiver. For all other mining claims or sites waived, you must record a notice of intent to hold on or before the December 30th immediately following the filing of this waiver.
9. Mill and tunnel sites may also be listed on this waiver and be waived from payment of the maintenance fee. A notice of intent to hold for these sites is required to be filed by the December 30th following the filing of this waiver.

G POL'S  
G NOI'S  
ENTERED  
✓ \$ GO OVER  
PAYMENT

FOR OFFICIAL USE ONLY



UNITED STATES  
DEPARTMENT OF THE INTERIOR  
BUREAU OF LAND MANAGEMENT  
**MAINTENANCE FEE PAYMENT FORM  
FOR PLACER MINING CLAIMS**

430544

Remitter Name: Christopher A Miller  
Mailing Address: 16170 West Dynamite Blvd  
City, State, Zip: Surprise AZ 85387

Check here if this is a change of address.

**FOR COUNTY RECORDER'S USE**

No. of claims 6  
Total due BLM \$ \$160.00  
CK # 1238

- The maintenance fee may be paid by cash, check, money order, Bureau of Land Management (BLM) Declining Deposit Account, or credit card (VISA, American Express, Discover, or MasterCard). Payments must be remitted to the BLM State Office where your claim or site is recorded and received on or before September 1. If the payment is mailed, the envelope must be postmarked by a bona fide delivery service on or before September 1 and received at the proper BLM State Office within 15 calendar days after the due date. Payments may also be made by telephone using a credit card. A complete listing of BLM State Offices with their addresses and phone numbers can be found at <http://www.blm.gov>.
- The maintenance fee for the following claim(s) applies to the assessment year 2015.

CLAIM NAME	BLM SERIAL NO.	ACRES IN CLAIM	PAYMENT DUE TO THE BLM (See Instructions on Page 2)
Maverick-2	AMC 430544	20	\$ 10.00
Maverick-3	AMC 430545	20	\$ 10.00
Maverick-4	AMC 430546	20	\$ 10.00
Maverick-5	AMC 430547	20	\$ 10.00
Maverick-6	AMC 430548	20	\$ 10.00
Maverick-7	AMC 430549	20	\$ 10.00

ENTERED  
AUG 20 2015  
BY: [Signature]

RECEIVED  
BLM AZ STATE OFFICE  
2015 AUG 17 P 2:49

Use a separate sheet for additional claim names, serial numbers, and claimant names and addresses.

(Continued on page 2)

**RECEIPT # 3370284**



## INSTRUCTIONS

1. This is an optional form that may be used to satisfy the requirements for the Bureau of Land Management (BLM) under the provisions of 43 U.S.C. §1744 and 30 U.S.C. §28f and the regulations thereunder (43 CFR part 3834). Since local and State laws may vary, you should contact your local and State agencies where the claims are located to ensure all applicable laws and requirements are satisfied.
2. This form should be used to pay the maintenance fee for placer mining claims only. To pay the maintenance fee for lode mining claims, mill sites or tunnel sites, use Form 3830-5.
3. Complete the section for the number of claims and the amount being remitted to the BLM.
4. Enter the year in paragraph 2 for the applicable assessment year.
5. List all mining claim names and the BLM serial number associated to the claim if the BLM has notified you what the serial number is. Every attempt should be made to include the current BLM serial number for each claim listed. List the acreage for each claim and the amount due based on the acreage. See the chart below for amounts due.
6. The maintenance fee for placer mining claims is paid for every 20 acres of the claim **or portion thereof**. When making a maintenance fee payment for your placer claim, you should make your payment in accordance with the following chart:

Number of acres in the claim	Maintenance Fee Payment Due Per Claim
< = 20 acres	\$155
> 20 acres but < = 40 acres	\$310
> 40 acres but < = 60 acres	\$465
> 60 acres but < = 80 acres	\$620
> 80 acres but < = 100 acres	\$775
> 100 acres but < = 120 acres	\$930
> 120 acres but < = 140 acres	\$1,085
> 140 acres but < = 160 acres	\$1,240
> 160 acres	Contact the BLM

Legend: > means greater than; < means less than; = means equal to

7. The name and current mailing addresses of the person paying the maintenance fee(s) should be listed at the top of the form. If this is a change of address for a claimant, that should also be noted.
8. If needed, an additional sheet can be used to continue listing claim names, BLM serial numbers, acres in claim, payment due or the name and current mailing address of additional claimants.
9. If paying by credit card, you must complete the following credit card information on page 4: (a) exact name on the face of the credit card; (b) amount paid; (c) type of card; (d) credit card number; (e) expiration date of the card; and (f) telephone number. You must also sign page 4 to show authorization to charge the credit card.

## NOTICES

**THE PRIVACY ACT** and 43 CFR 2.48(d) require that you be furnished with the following information in connection with the information requested by this form.

**AUTHORITY:** 30 U.S.C. 28f and 43 CFR part 3834 permit collection of the information requested by this form.

**PRINCIPAL PURPOSE:** The BLM will use the information you provide to record the annual maintenance fee payment for the claims listed and to verify that payment has been made in accordance with 30 U.S.C. 28f and 43 CFR part 3834.

**ROUTINE USES:** The BLM will only disclose this information in accordance with the provisions at 43 CFR 2.56(b) and (c).

**EFFECT OF NOT PROVIDING INFORMATION:** Disclosure of the requested information is required by 30 U.S.C. 28f and 43 CFR part 3834 for claimants paying the annual maintenance fee. The use of this specific form when paying the maintenance fee is optional. However, when paying the maintenance fee, it is the requested information on this form that is required to be submitted along with the fee. Failure to submit all the required information will delay the BLM's processing of the information and may preclude the BLM's acceptance of the maintenance fee payment, which may result in forfeiture of the mining claim(s) by the claimant.

markings sufficient to appropriately designate the corner of the claim to which it pertains and the name of the claim(s).

I hereby certify under penalty of perjury under the laws of the State of ARIZONA that the foregoing statements are true and correct:

Chris A. Muhl Date: 8-15-2015  
(Signature of person responsible for above statement)

Title 18 U.S.C. 1001 and 43 U.S.C. 1212 make it a crime for any person knowingly and willfully to make to any department or agency of the United States any false, fictitious or fraudulent statements or representations as to any matter within its jurisdiction.

**Notary Block**

**SUBSCRIBED AND SWORN TO** before me, this \_\_\_\_\_ day of \_\_\_\_\_ 20\_\_

By: \_\_\_\_\_  
(Signature of Affiant)

Title: \_\_\_\_\_

My Commission Expires: \_\_\_\_\_

RECEIVED  
BLM AZ STATE OFFICE  
2015 AUG 17 P 2:50  
PHOENIX, ARIZONA

**INSTRUCTIONS**

1. This is an optional form that may be used to satisfy the requirements for the Bureau of Land Management (BLM) under the provisions of 43 U.S.C. §1744 and 30 U.S.C. §28-28d and the regulations thereunder (43 CFR part 3835). Since local and State laws may vary, you should contact your local and State agencies where the claims are located to ensure all applicable laws and requirements are satisfied.
2. The claimant(s) must fill in the date in paragraph 1 for the applicable assessment year and the county and state where the claims are located.
3. All claim names, BLM serial numbers, legal descriptions, and original county recording information must be listed for the claims pertaining to this assessment notice.
4. The claimant(s) must complete paragraph 2 listing all labor or improvements which was performed on or did benefit the subject mining claims. The value and date of the labor or improvements must also be listed. The total amount of labor or improvements can be listed, but the total expenditure must equal at least \$100 for each claim.
5. The names and current mailing addresses of the person(s) performing the labor shall be listed in paragraph 3.
6. The name and current mailing address of each owner (claimant) of the claims shall be listed in paragraph 4. The mailing address shall be the owner's address and not the address of an agent or anyone representing the claimant. Be sure to note if there has been a change of address.
7. Paragraph 5 shall be completed to show the date it was verified that all monuments required by law were properly erected, all notices were posted, and that corners were appropriately designated for all claims listed.
8. An exact legible reproduction or duplicate (other than microfilm or other electronic media) of this affidavit or another type of affidavit of assessment work that you file or will file in the county where each claim is located, must be filed with the BLM on or before December 30 of the calendar year in which the assessment year ends. For mill or tunnel sites, a separate notice of intent to hold must be filed with the BLM on or before December 30. Requirements for filing a notice of intent to hold can be found at 43 CFR 3835.33.
9. A processing fee of \$10 for each claim listed must be remitted to the BLM along with this or any other affidavit of assessment work.

## NOTICES

**THE PRIVACY ACT** and 43 CFR 2.48(d) require that you be furnished with the following information in connection with the information requested by this form.

**AUTHORITY:** 30 U.S.C. §28-28d and 43 CFR part 3835 permit collection of the information requested by this form.

**PRINCIPAL PURPOSE:** The BLM will use the information you provide to document compliance with 43 U.S.C. 1744 and that assessment work has been completed in accordance with 30 U.S.C. § 28-28d and 43 CFR part 3835 in lieu of paying the maintenance fee for the mining claims listed on this form.

**ROUTINE USES:** The BLM will only disclose this information in accordance with the provisions at 43 CFR 2.56(b) and (c).

**EFFECT OF NOT PROVIDING INFORMATION:** Disclosure of the requested information is required by 30 U.S.C. § 28-28d and 43 CFR part 3835 for claimants qualified to perform assessment work in lieu of paying the maintenance fee. Failure to submit all the requested information or to complete this form will delay the BLM's processing of the form and may preclude the BLM's acceptance of the assessment work information, which may result in forfeiture of the mining claim(s) by the claimant.

**THE PAPERWORK REDUCTION ACT** requires us to inform you that:

Use of this form is optional. You must perform assessment if a waiver to pay the maintenance fee has been requested. This form is provided to help you attest that annual assessment work has been completed in lieu of paying the maintenance fee for your claim(s). Submission of the requested information is necessary to obtain or retain a benefit.

You do not have to respond to this or any other Federal agency-sponsored information collection unless it displays a valid OMB control number.

**BURDEN HOURS STATEMENT:** The estimated public reporting burden for this form is 30 minutes per response, including the time for reviewing instructions, gathering and maintaining data, and completing and reviewing the form. You may submit comments regarding the burden estimate or any other aspect of this form to: U.S. Department of the Interior, Bureau of Land Management (1004-0114), Bureau Information Collection Clearance Officer (WO-630), 1849 C Street, N.W., Room 2134LM, Washington, D.C. 20240.



430544

**NOTICE OF INTENTION TO HOLD MINING CLAIMS/SITES**

When Recorded Return Document to:

Christopher A. Miller  
16170 W Dynamite Blvd  
Surprise AZ 85307

BLM  
Date  
Stamp

RECEIVED  
BLM AZ SITE OFFICE  
2015 AUG 17 P 2:50  
PHOENIX, ARIZONA

Check here if this is a change of address.  
Telephone: \_\_\_\_\_  
E-mail Address: \_\_\_\_\_

I (We) intend to hold the claims(s) and/or site(s) listed below for the calendar year 20\_\_\_\_, and I (We) have filed or will file a Notice of Intent to Hold in the county where the claim (s) is located.

Reason for filing a Notice of Intent to Hold instead of an assessment work filing (check one):

- Maintenance fee was paid to maintain claim(s) during this assessment year.
- Mill or tunnel sites.
- Claim(s) was located during the current assessment year.
- BLM has deferred assessment work (attach copy of decision granting deferment, or pending petition for deferment including date petition was filed.)

Line No.	AMC NUMBER	CLAIM/SITE NAME	COUNTY RECORDER DATA (If available)	TWP	RNG	SEC
1	430544	Maverick-2		26	11N	1E
2	430545	Maverick-3		26	11N	1E
3	430546	Maverick-4		26	11N	1E
4	430547	Maverick-5		26	11N	1E
5	430548	Maverick-6		26	11N	1E
6	430549	Maverick-7		26	11N	1E
7						
8						
9						
10						

ENTERED  
AUG 20 2015  
BY: R. W. W.



NOTICE OF INTENTION TO HOLD MINING CLAIMS/SITES  
page 2

RECEIVED  
BLM AZ STATE OFFICE  
2015 AUG 17 P 2:50  
PHOENIX, ARIZONA  
BLM  
Date  
Stamp

1. State of Arizona, County of YAVAPAI

2. I (Name) Christopher A Miller

3. Reside at (Address) 16170 W Dynamite Blvd

City Surprise County Maricopa State AZ Zip 85307 being duly sworn, depose and say that I am a citizen of the United States, more than eighteen years of age, that all of the facts set forth in this notice, subject to the provisions and penalties of 18 U.S.C. 1001 pertaining to the filing of false, fictitious, or fraudulent statements with the United States, are true and correct according to the best of my knowledge, information and belief.

4. Owner's name and address (If not shown in Items 1-3 above). \_\_\_\_\_

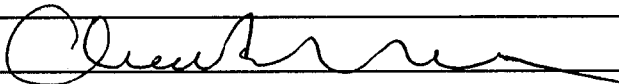
5. Dated: 8-15-2015 Signature: 

Bureau of Land Management  
Arizona State Office  
[www.blm.gov/az](http://www.blm.gov/az)

No. of Claims: 6 x \$10 = 6000  
Check No: 1237 Init. AA  
Receipt No.: 3370284  
For BLM Use Only

**AFFIDAVIT OF ANNUAL ASSESSMENT WORK**

WHEN RECORDED, MAIL DOCUMENT TO:

NAME: Christopher A Miller

ADDRESS: 16170 W Dynamite Blvd

CITY, STATE, ZIP: Surprise AZ 85397

FOR COUNTY RECORDER'S USE

No. of Claims \_\_\_\_\_

x \$10/claim

Total due BLM \$ \_\_\_\_\_

TO ALL WHOM IT MAY CONCERN:

1. The undersigned certifies that at least \$100 per claim was expended for development, labor and improvements, or equivalent value added, as the annual assessment work for the assessment year ending September 1, 2015 for the following contiguous unpatented mining claim(s), located in the County of YAVAPAI, in the State of ARIZONA.

BLM Serial No.	Name of Claim	Tp Rg Sec Mer Example: 13N 5E 14 MDM				County Recordation Book and Page No.	Date
AMC 430544	Maverick-2	26	11N	1E	6SRB		8-15-2015
AMC 430545	Maverick-3	26	11N	1E	6SRB		8-15-2015
AMC 430546	Maverick-4	26	11N	1E	6SRB		8-15-2015
AMC 430547	Maverick-5	26	11N	1E	6SRB		8-15-2015
AMC 430548	Maverick-6	26	11N	1E	6SRB		8-15-2015
AMC 430549	Maverick-7						

RECEIVED  
BLM AZ STATE OFFICE  
2015 AUG 17 P 2:50  
PHOENIX, ARIZONA

RECEIVED  
BLM ARIZONA OFFICE  
PHOENIX, ARIZONA  
2015 AUG 17 P 2:50  
BLM  
Date  
Stamp

7					
8					
9					
10					

6. That between the dates starting at 12 o'clock noon on September 1, 20 14 and ending at 12 o'clock noon on September 1, 20 15 at least \$ 100,000 dollars worth of work and improvements were done and performed upon said claim(s) or upon one or more of a contiguous group of claims for the benefit of all, wholly or partly outside of a contiguous group of claims for the benefit of all, not including the location work.

7. That the following persons were employed to perform the work and improvements described herein: Christopher A. Miller / Jonelle M Anderson misc Friends & family

8. That the work and improvements performed were: Erecting Monuments/corners / Mining, Trash Removal

9. Dated: 8-15-2015 Signature [Signature]

SUBSCRIBED AND SWORN TO before me, a Notary Public, this \_\_\_\_\_ day of \_\_\_\_\_ 20\_\_\_\_

By: \_\_\_\_\_

Notary Public \_\_\_\_\_

My Commission Expires \_\_\_\_\_

Bureau of Land Management  
Arizona State Office  
[www.blm.gov/az](http://www.blm.gov/az)

No. of Claims: 6 x \$10 = \$6000  
Check No.: 1236 Init. \_\_\_\_\_  
Receipt No.: \_\_\_\_\_  
For BLM Use Only





PLEASE CONTACT ME IF  
ANY CLERICAL ERRORS,  
OR ANY OTHER CONCERNS,

THANK YOU

Chris Miller

623-687-6538

PHOENIX, ARIZONA  
2015 AUG 17 P 2:49  
RECEIVED  
BLM AZ STATE OFFICE

Miller  
16170 W Diamond Blvd  
Surprise AZ 85387



AZ BLM office  
1 North Central Ave suite 800  
Phoenix, ARIZONA 85004-4427

PHOENIX, ARIZONA  
2015 AUG 17 P 2:49  
RECEIVED  
BLM AZ STATE OFFICE

950482922



**United States Department of the Interior**  
**Bureau of Land Management**  
 LANDS/RECREATION & PLANNING  
 ONE N CENTRAL AVE  
 PHOENIX, AZ 85004 -2203  
 Phone: 602-417-9200

Receipt

No: 3370284

<b>Transaction #:</b> 3468438
<b>Date of Transaction:</b> 08/18/2015
<b>CUSTOMER:</b>
CHRISTOPHER MILLER 16170 W DYNAMITE BLVD SURPRISE, AZ 85387-6704 US

LINE #	QTY	DESCRIPTION	REMARKS	UNIT PRICE	TOTAL
1	1.00	LOCATABLE MINERALS / MINING CLAIMS-NOT NEW-UNADJUD, ONE AUTH NO. ONLY / MINING CLAIM MONEY RECEIVED <b>CASES:</b> AMC430544/\$60.00	MAINT FEE WAIVER (6) 2016 / POL (6) 2015	- n/a -	60.00
2	1.00	LOCATABLE MINERALS / MINING CLAIMS-NOT NEW-UNADJUD, ONE AUTH NO. ONLY / MINING CLAIM MONEY RECEIVED <b>CASES:</b> AMC430544/\$60.00	NOI (6) 2015	- n/a -	60.00
3	1.00	LOCATABLE MINERALS / MINING CLAIMS-NOT NEW-UNADJUD, ONE AUTH NO. ONLY / MINING CLAIM MONEY RECEIVED <b>CASES:</b> AMC430544/\$60.00	POL (6) 2015	- n/a -	60.00
<b>TOTAL:</b>					<b>\$180.00</b>

*REFUNDED  
ON 9/14/15  
EK*

PAYMENT INFORMATION			
1	AMOUNT:	60.00	POSTMARKED: N/A
	TYPE:	CHECK	RECEIVED: 08/17/2015
	CHECK NO:	1236	
	NAME:	MILLER, CHRISTOPHER 16170 W DYNAMITE BLVD SURPRISE AZ 85387-6704 US	
2	AMOUNT:	60.00	POSTMARKED: N/A
	TYPE:	CHECK	RECEIVED: 08/17/2015
	CHECK NO:	1237	

8/18/2015

	NAME:	MILLER, CHRISTOPHER 16170 W DYNAMITE BLVD SURPRISE AZ 85387-6704 US	
3	AMOUNT:	60.00	POSTMARKED: N/A
	TYPE:	CHECK	RECEIVED: 08/17/2015
	CHECK NO:	1238	
	NAME:	MILLER, CHRISTOPHER 16170 W DYNAMITE BLVD SURPRISE AZ 85387-6704 US	

REMARKS

This receipt was generated by the automated BLM Collections and Billing System and is a paper representation of a portion of the official electronic record contained therein.

  
 BY: \_\_\_\_\_  
 INTERE  
 AUG 20 2015



**Authorized Date**09/14/2015

**Instructions to Accounts** AZ BLM REFUND TO CHRISTOPHER MILLER \$60.00 FOR  
OVERPAYMENT OF FEES ON AMC430544 RECEIPT NBR 3370284 IR

**Login ID**6771

**Entry Date**09/14/2015

**Total Amount**\$60.00

**NOTICE!!**

**These documents have been scanned!**

**Do not place un-scanned documents beneath this notice!**

**Do not remove this notice from this file!**

GPO Jacket No. 560-102  
Print Order 61540  
Rise Business Services, LLC  
Job=AZ15 5/9/2019



Box Number= AZ15029



Claim Begin-End: AMC430544-AMC430549

5 Miscellaneous



AZ15029-27

AMC430302-AMC430580

**NO  
DOCUMENTS  
FOUND**

NO DOCUMENTS FOUND  
NO DOCUMENTS FOUND



**NOTICE!!**

**These documents have been scanned!**

**Do not place un-scanned documents beneath this notice!**

**Do not remove this notice from this file!**

GPO Jacket No. 560-102  
Print Order 61540  
Rise Business Services, LLC  
Job=AZ15 5/9/2019



Box Number= AZ15029



Claim Begin-End: AMC430544-AMC430549

6 Location Notices-Amendments and Supporting Documents



AZ15029-27

AMC430302-AMC430580



# MINING CLAIM STATUS REPORT

Data Entered: 03/10/15 RAm

MTP Checked By: 03/10/15 RAm

GEO Checked By: 03/10/16 RAm

LEAD SERIAL NUMBER: AMC 430544 thru AMC 430549

### NUMBER OF CLAIMS & TYPE:

\_\_\_\_ LODGE  
6 PLACER  
\_\_\_\_ ASSOCIATION PLACER  
\_\_\_\_ MILL SITE  
\_\_\_\_ TUNNEL SITE

### CHARGES:

Location Fee @ \$37 = \$ 222.00  
Processing Fee @ \$20 = \$ 120.00  
Maintenance Fee @ \$155 = \$ 930.00  
Add'l Maint Fee for Assoc Placer = \$ \_\_\_\_\_  
**SUBTOTAL** \$ 1272.00  
Other Fees \$ \_\_\_\_\_  
Other Fees \$ \_\_\_\_\_  
**TOTAL** \$ 1272.00

TOTAL ACREAGE: 20 Per Claim  
(Placer Only)

NUMBER OF LOCATORS: 1

DOCUMENTS RECEIVED VIA: Over-the-Counter [ ] Mail [  ] **TIMELY FILED:** Yes [  ] No [ ]

LEGAL DESCRIPTION: T 11N R 1E SEC 24, 26  
T \_\_\_\_\_ R \_\_\_\_\_ SEC \_\_\_\_\_  
T \_\_\_\_\_ R \_\_\_\_\_ SEC \_\_\_\_\_  
T \_\_\_\_\_ R \_\_\_\_\_ SEC \_\_\_\_\_  
T \_\_\_\_\_ R \_\_\_\_\_ SEC \_\_\_\_\_

BLM [ ] FOREST SERVICE [ ] \_\_\_\_\_ SUBJ TO PL 359: Yes [ ] No [ ]  
WILDERNESS AREA [ ] \_\_\_\_\_

SPLIT ESTATE: N/A [ ] SX [ ] PX [ ] OTHER [ ] \_\_\_\_\_  
SRHA [ ] Was proper Notice filed if located on SHRA Land? Yes [ ] No [ ]

RECONVEYED MINERALS ON BLM LAND REQUIRE OPENING ORDER FROM 1944 TO 1993:  
Open to Entry On \_\_\_\_\_ N/A [ ]

COMMENTS/STATUS: VOID [ ] PARTIALLY VOID [ ] PVT MINERALS [ ] WITHDRAWN LANDS [ ]  
OTHER [ ] \_\_\_\_\_

[ ] Claimant acknowledges that portions of the following claim(s) site(s) may be void or voidable.

Printed Name of Claimant \_\_\_\_\_ Signature of Claimant \_\_\_\_\_

\*\*\*\*\*FINAL ADJUDICATION\*\*\*\*\*  
DATE APR 20 2015 INITIALS PR

AMC 430544

When Recorded Return Document to:

CHRISTOPHER A MILLER

16170 WEST DYNAMITE BLVD

SURPRISE, AZ

85387

Check here is this is a change of address.

Telephone: \_\_\_\_\_

E-mail address: \_\_\_\_\_

**LOCATION NOTICE FOR PLACER MINING CLAIM**

Amendment BLM Serial # \_\_\_\_\_

NOTICE IS HEREBY GIVEN that the MAVERICK 2

\_\_\_\_\_ placer mining claim has been located by

CHRISTOPHER A MILLER whose current mailing

address is 16170 W DYNAMITE BLVD

SURPRISE, AZ 85387

BLM  
Date  
Stamp

2015 MAR - 5 P 2:56  
MILLER, CHRISTOPHER A

The general course of this claim is EASTERLY and it is situated in YAVAPAI

County, Arizona. This claim is 1320 feet in length and 660 feet in width.

20 Total Claim Acreage. This claim runs from the location monument on which this location notice is

posted at the NW corner of the claim approximately 1320 feet in a EASTERLY direction to the

NE end line and 660 feet in a SOUTHERLY direction to the SE end line. This claim is

marked by four monuments, one at each corner of the claim.

The location monument on which this notice is posted is situated within Section 26, Township

11 NORTH, Range 1 EAST, Gila Salt River Base and Meridian, Arizona. This claim encompasses

portions of the following legal subdivision(s) if located by legal subdivision or the following quarter section(s),

section(s), Township(s) and Range(s) NW 1/4 T11 R1E

\_\_\_\_\_, Gila Salt River Base and Meridian, Arizona.

The locality of this claim with reference to some natural object or permanent monument and additional information

(if any) concerning its locality are as follows: JUST SOUTH OF CLEATOR, ARIZONA OFF FORREST SERVICE

ROAD 687

\_\_\_\_\_ The above information is shown on the attached map.

DATED AND POSTED on the ground this 28 day of FEBRUARY, 20 15.

LOCATOR(s)  AGENT

Print Name(s) CHRISTOPHER A MILLER

Signature(s) \_\_\_\_\_

Form MCF102  
Revised July 2014

This form is available from the Arizona Geological Survey and may be reproduced.

AMC430544

**MINING CLAIM MAP**

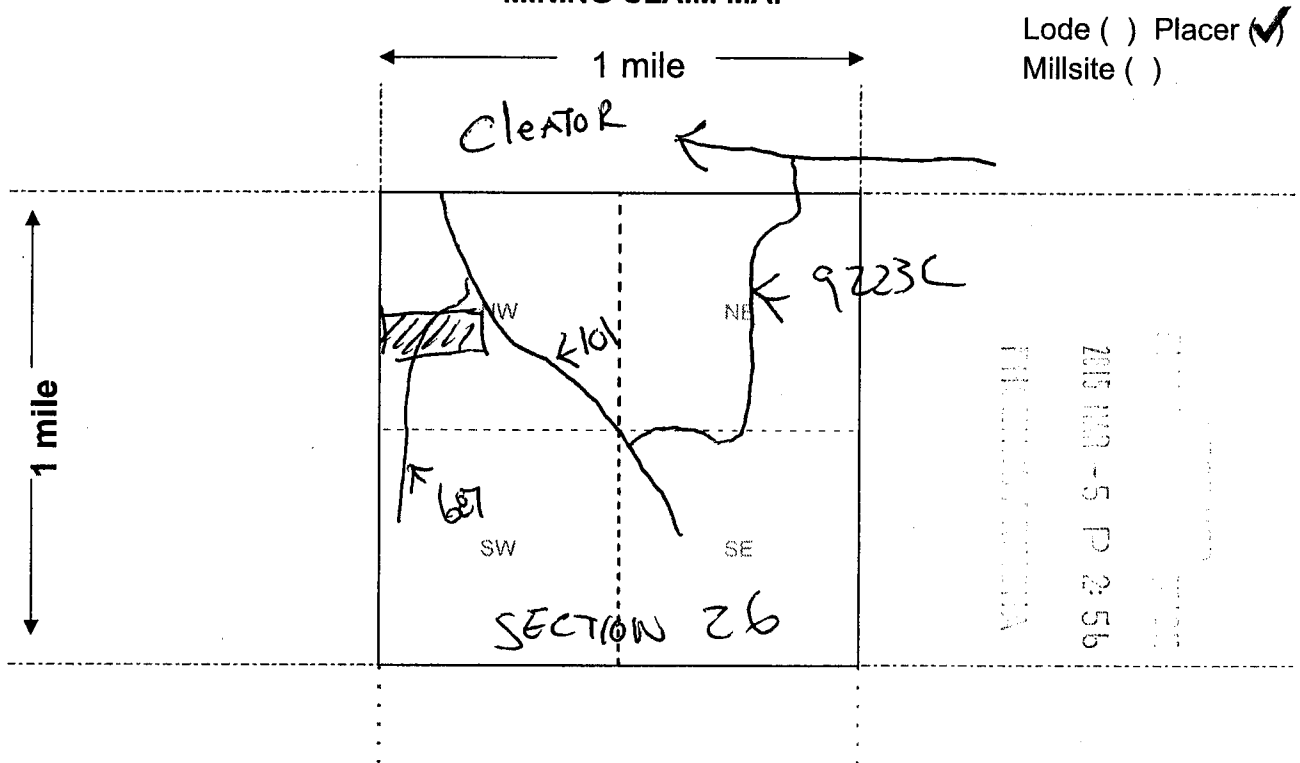

Scale: 1" = 2000 feet



1. The above map depicts the MAVERICK 2 mining claim, which is located in Section (s) 26, Township 11 NORTH, Range 1 EAST, Gila and Salt River Base and Meridian, YAVAPAI County, Arizona. Total claim acreage is 20
2. The type of corner and location monuments used are as follows: 2X2 WHITE PVC CORNER MARKERS
3. The bearings and distances in degrees and feet between claim corners and to a public land survey monument are as depicted on the map.
4. If the claim is a placer or millsite claim with exterior limits conforming to legal subdivisions of the public survey, provide a legal description of the claim \_\_\_\_\_

AHC430544

Form MCF100a  
Revised July 2014

This form is available from the Arizona Geology Survey and may be reproduced.

When Recorded Return Document to:  
CHRISTOPHER A MILLER  
16170 WEST DYNAMITE BLVD  
SURPRISE, AZ  
85387

Check here is this is a change of address.  
Telephone: \_\_\_\_\_  
E-mail address: \_\_\_\_\_

**LOCATION NOTICE FOR PLACER MINING CLAIM**  
 Amendment BLM Serial # \_\_\_\_\_  
NOTICE IS HEREBY GIVEN that the MAVERICK 3  
\_\_\_\_\_ placer mining claim has been located by  
CHRISTOPHER A MILLER whose current mailing  
address is 16170 W DYNAMITE BLVD  
SURPRISE, AZ 85387

BLM  
Date  
Stamp  
PHOENIX, ARIZONA  
2015 MAR -5 P 2:55

The general course of this claim is EASTERLY and it is situated in YAVAPAI  
County, Arizona. This claim is 1320 feet in length and 660 feet in width.  
20 Total Claim Acreage. This claim runs from the location monument on which this location notice is  
posted at the NW corner of the claim approximately 1320 feet in a EASTERLY direction to the  
NE end line and 660 feet in a SOUTHERLY direction to the SE end line. This claim is  
marked by four monuments, one at each corner of the claim.

The location monument on which this notice is posted is situated within Section 26, Township  
11 NORTH, Range 1 EAST, Gila Salt River Base and Meridian, Arizona. This claim encompasses  
portions of the following legal subdivision(s) if located by legal subdivision or the following quarter section(s),  
section(s), Township(s) and Range(s) NW 1/4 T11 R1E  
\_\_\_\_\_, Gila Salt River Base and Meridian, Arizona.

The locality of this claim with reference to some natural object or permanent monument and additional information  
(if any) concerning its locality are as follows: JUST SOUTH OF CLEATOR, ARIZONA OFF FORREST SERVICE  
ROAD 687

\_\_\_\_\_ The above information is shown on the attached map.

DATED AND POSTED on the ground this 28 day of FEBRUARY, 20 15.  
 LOCATOR(s)  AGENT

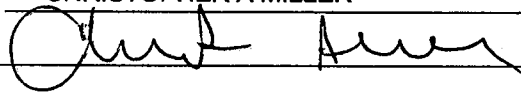
Print Name(s) CHRISTOPHER A MILLER  
Signature(s) 

Form MCF102  
Revised July 2014

AMC430545



**MINING CLAIM MAP**

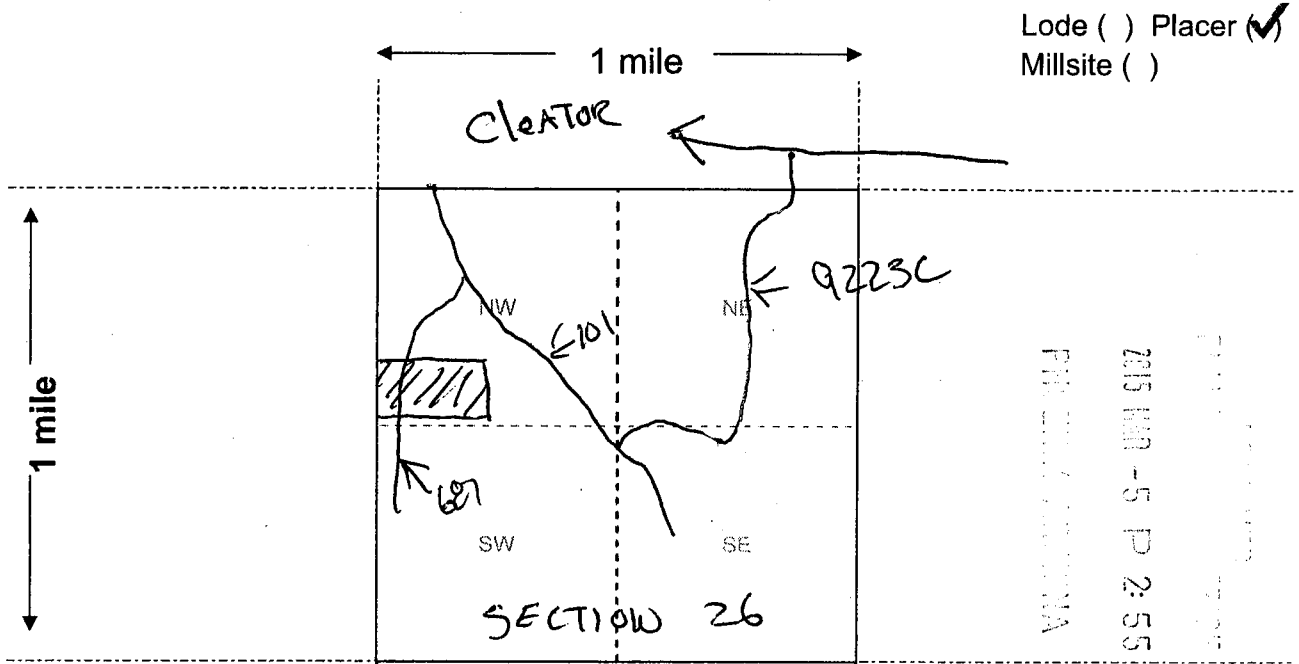

Scale: 1" = 2000 feet



1. The above map depicts the MAVERICK 3 mining claim, which is located in Section (s) 26, Township 11 NORTH, Range 1 EAST, Gila and Salt River Base and Meridian, YAVAPAI County, Arizona. Total claim acreage is 20
2. The type of corner and location monuments used are as follows: 2X2 WHITE PVC CORNER MARKERS
3. The bearings and distances in degrees and feet between claim corners and to a public land survey monument are as depicted on the map.
4. If the claim is a placer or millsite claim with exterior limits conforming to legal subdivisions of the public survey, provide a legal description of the claim \_\_\_\_\_

Form MCF100a  
Revised July 2014

This form is available from the Arizona Geology Survey and may be reproduced.

AMC430545

When Recorded Return Document to:  
CHRISTOPHER A MILLER  
16170 WEST DYNAMITE BLVD  
SURPRISE, AZ  
85387

Check here is this is a change of address.  
Telephone: \_\_\_\_\_  
E-mail address: \_\_\_\_\_

**LOCATION NOTICE FOR PLACER MINING CLAIM**

Amendment BLM Serial # \_\_\_\_\_

NOTICE IS HEREBY GIVEN that the MAVERICK 4  
\_\_\_\_\_ placer mining claim has been located by  
CHRISTOPHER A MILLER whose current mailing  
address is 16170 W DYNAMITE BLVD  
SURPRISE, AZ 85387

BLM  
Date  
Stamp  
2015 MAR -5 P 2:54  
VINCENT J. FORTUNA

The general course of this claim is EASTERLY and it is situated in YAVAPAI  
County, Arizona. This claim is 1320 feet in length and 660 feet in width.

20 Total Claim Acreage. This claim runs from the location monument on which this location notice is  
posted at the NW corner of the claim approximately 1320 feet in a EASTERLY direction to the  
NE end line and 660 feet in a SOUTHERLY direction to the SE end line. This claim is  
marked by four monuments, one at each corner of the claim.

The location monument on which this notice is posted is situated within Section 26, Township  
11 NORTH, Range 1 EAST, Gila Salt River Base and Meridian, Arizona. This claim encompasses  
portions of the following legal subdivision(s) if located by legal subdivision or the following quarter section(s),  
section(s), Township(s) and Range(s) NW 1/4 T11 R1E  
\_\_\_\_\_, Gila Salt River Base and Meridian, Arizona.

The locality of this claim with reference to some natural object or permanent monument and additional information  
(if any) concerning its locality are as follows: JUST SOUTH OF CLEATOR, ARIZONA AT THE  
INTERSECTION OF FORREST ROAD 101 AND FORREST ROAD 687

\_\_\_\_\_ The above information is shown on the attached map.

DATED AND POSTED on the ground this 28 day of FEBRUARY, 20 15.

LOCATOR(s)  AGENT

Print Name(s) CHRISTOPHER A MILLER

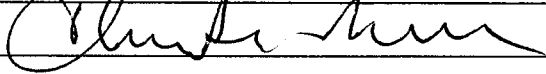
Signature(s) 

Form MCF102  
Revised July 2014

AMC430546

**MINING CLAIM MAP**

Lode ( ) Placer   
 Millsite ( )

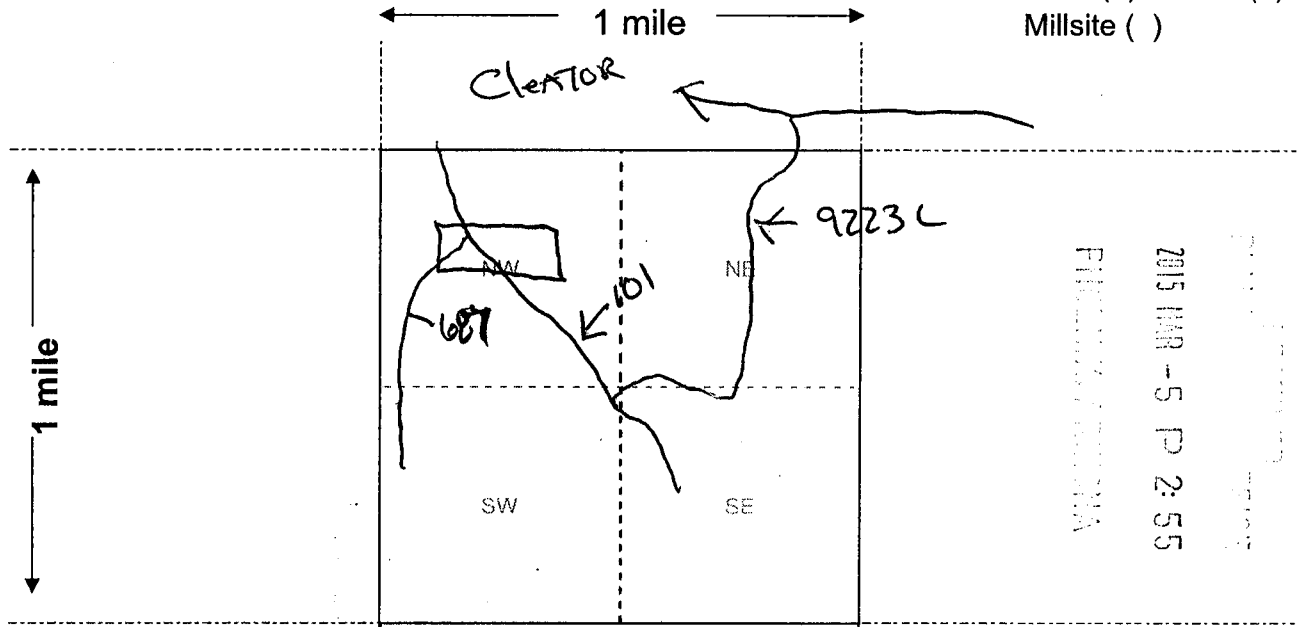

Scale: 1" = 2000 feet



1. The above map depicts the MAVERICK 4 mining claim, which is located in Section (s) 26, Township 11 NORTH, Range 1 EAST, Gila and Salt River Base and Meridian, YAVAPAI County, Arizona. Total claim acreage is 20
2. The type of corner and location monuments used are as follows: 2X2 WHITE PVC CORNER MARKERS
3. The bearings and distances in degrees and feet between claim corners and to a public land survey monument are as depicted on the map.
4. If the claim is a placer or millsite claim with exterior limits conforming to legal subdivisions of the public survey, provide a legal description of the claim \_\_\_\_\_

**Form MCF100a**  
 Revised July 2014

This form is available from the **Arizona Geology Survey** and may be reproduced.

AMC430546

When Recorded Return Document to:  
CHRISTOPHER A MILLER  
16170 WEST DYNAMITE BLVD  
SURPRISE, AZ  
85387

Check here is this is a change of address.

Telephone: \_\_\_\_\_

E-mail address: \_\_\_\_\_

**LOCATION NOTICE FOR PLACER MINING CLAIM**

Amendment BLM Serial # \_\_\_\_\_

NOTICE IS HEREBY GIVEN that the MAVERICK 5

\_\_\_\_\_ placer mining claim has been located by

CHRISTOPHER A MILLER whose current mailing

address is 16170 W DYNAMITE BLVD

SURPRISE, AZ 85387

BLM  
Date  
Stamp  
FEBRUARY 28 2015  
10:55 AM -5 P 2:55

The general course of this claim is NORTHERLY and it is situated in YAVAPAI

County, Arizona. This claim is 1320 feet in length and 660 feet in width.

20 Total Claim Acreage. This claim runs from the location monument on which this location notice is

posted at the NE corner of the claim approximately 1320 feet in a SOUTHERLY direction to the

SE end line and 660 feet in a WESTERLY direction to the SW end line. This claim is

marked by four monuments, one at each corner of the claim.

The location monument on which this notice is posted is situated within Section 26, Township

11 NORTH, Range 1 EAST, Gila Salt River Base and Meridian, Arizona. This claim encompasses

portions of the following legal subdivision(s) if located by legal subdivision or the following quarter section(s),

section(s), Township(s) and Range(s) NE 1/4 T11 R1E

\_\_\_\_\_, Gila Salt River Base and Meridian, Arizona.

The locality of this claim with reference to some natural object or permanent monument and additional information

(if any) concerning its locality are as follows: JUST SOUTH OF CLEATOR, ARIZONA OFF FORREST SERVICE

ROAD 9223 C

\_\_\_\_\_ The above information is shown on the attached map.

DATED AND POSTED on the ground this 28 day of FEBRUARY, 20 15.

LOCATOR(s)  AGENT

Print Name(s) CHRISTOPHER A MILLER

Signature(s) *Christopher A Miller*

Form MCF102  
Revised July 2014

AMC430547



**MINING CLAIM MAP**

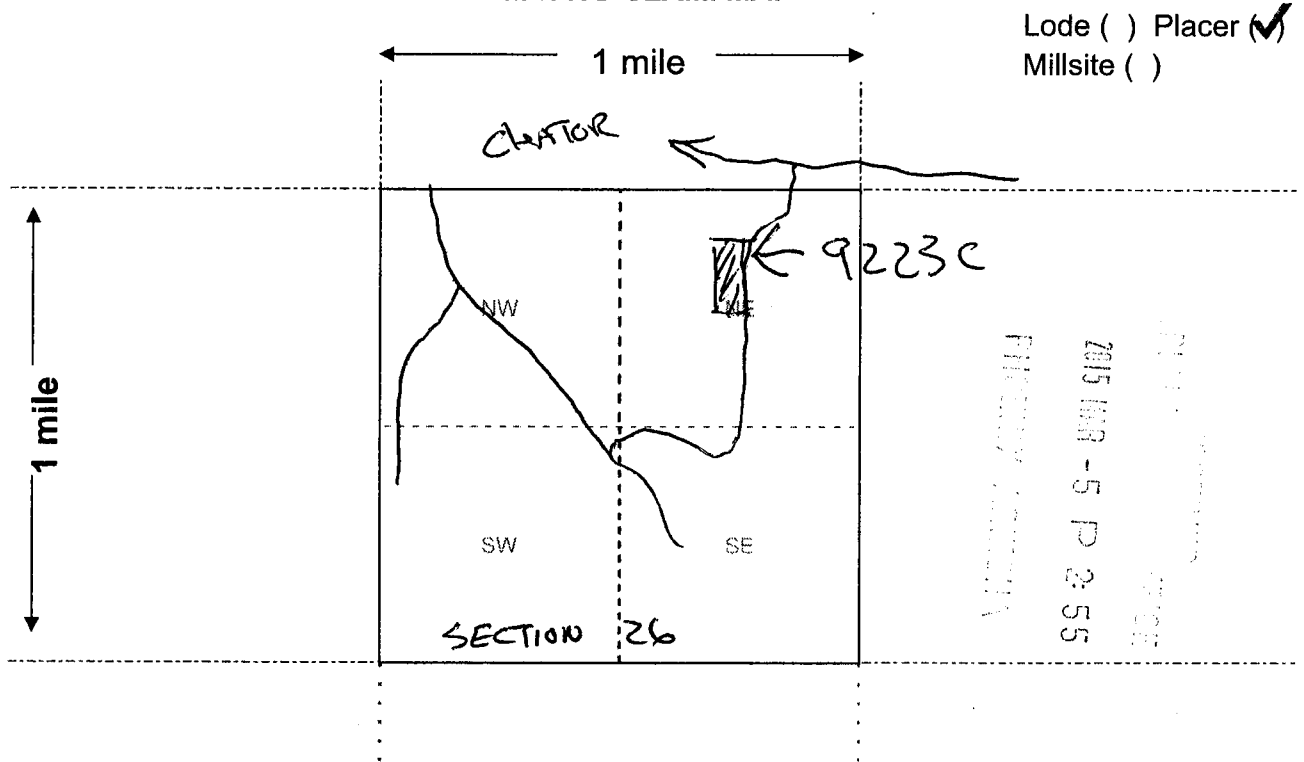

Lode ( ) Placer   
 Millsite ( )

1 mile

1 mile

Scale: 1" = 2000 feet



- The above map depicts the MAVERICK 5 mining claim, which is located in Section (s) 26, Township 11 NORTH, Range 1 EAST, Gila and Salt River Base and Meridian, YAVAPAI County, Arizona. Total claim acreage is 20
- The type of corner and location monuments used are as follows: 2X2 WHITE PVC CORNER MARKERS
- The bearings and distances in degrees and feet between claim corners and to a public land survey monument are as depicted on the map.
- If the claim is a placer or millsite claim with exterior limits conforming to legal subdivisions of the public survey, provide a legal description of the claim \_\_\_\_\_

AMC4305471

Form MCF100a  
 Revised July 2014

This form is available from the **Arizona Geology Survey** and may be reproduced.

When Recorded Return  sent to:  
CHRISTOPHER A MILLER  
16170 WEST DYNAMITE BLVD  
SURPRISE, AZ  
85387

Check here if this is a change of address.

Telephone: \_\_\_\_\_

E-mail address: \_\_\_\_\_

**LOCATION NOTICE FOR PLACER MINING CLAIM**

Amendment BLM Serial # \_\_\_\_\_

NOTICE IS HEREBY GIVEN that the MAVERICK 6

\_\_\_\_\_ placer mining claim has been located by

CHRISTOPHER A MILLER whose current mailing

address is 16170 W DYNAMITE BLVD

SURPRISE, AZ 85387

BLM  
Date  
Stamp

RECEIVED  
2015 MAR -5 P 2:51  
MILLER, CHRISTOPHER A

The general course of this claim is NORTHERLY and it is situated in YAVAPAI

County, Arizona. This claim is 1320 feet in length and 660 feet in width.

20 Total Claim Acreage. This claim runs from the location monument on which this location notice is

posted at the NE corner of the claim approximately 1320 feet in a SOUTHERLY direction to the

SE end line and 660 feet in a WESTERLY direction to the SW end line. This claim is

marked by four monuments, one at each corner of the claim.

The location monument on which this notice is posted is situated within Section 26, Township

11 NORTH, Range 1 EAST, Gila Salt River Base and Meridian, Arizona. This claim encompasses

portions of the following legal subdivision(s) if located by legal subdivision or the following quarter section(s),

section(s), Township(s) and Range(s) NE 1/4 T11 R1E

\_\_\_\_\_, Gila Salt River Base and Meridian, Arizona.

The locality of this claim with reference to some natural object or permanent monument and additional information

(if any) concerning its locality are as follows: JUST EAST OF CLEATOR, ARIZONA OFF FORREST SERVICE

ROAD 9223 C

\_\_\_\_\_ The above information is shown on the attached map.

DATED AND POSTED on the ground this 28 day of FEBRUARY, 20 15.

LOCATOR(s)  AGENT

Print Name(s) CHRISTOPHER A MILLER

Signature(s) 

Form MCF102  
Revised July 2014

AMC430548

**MINING CLAIM MAP**

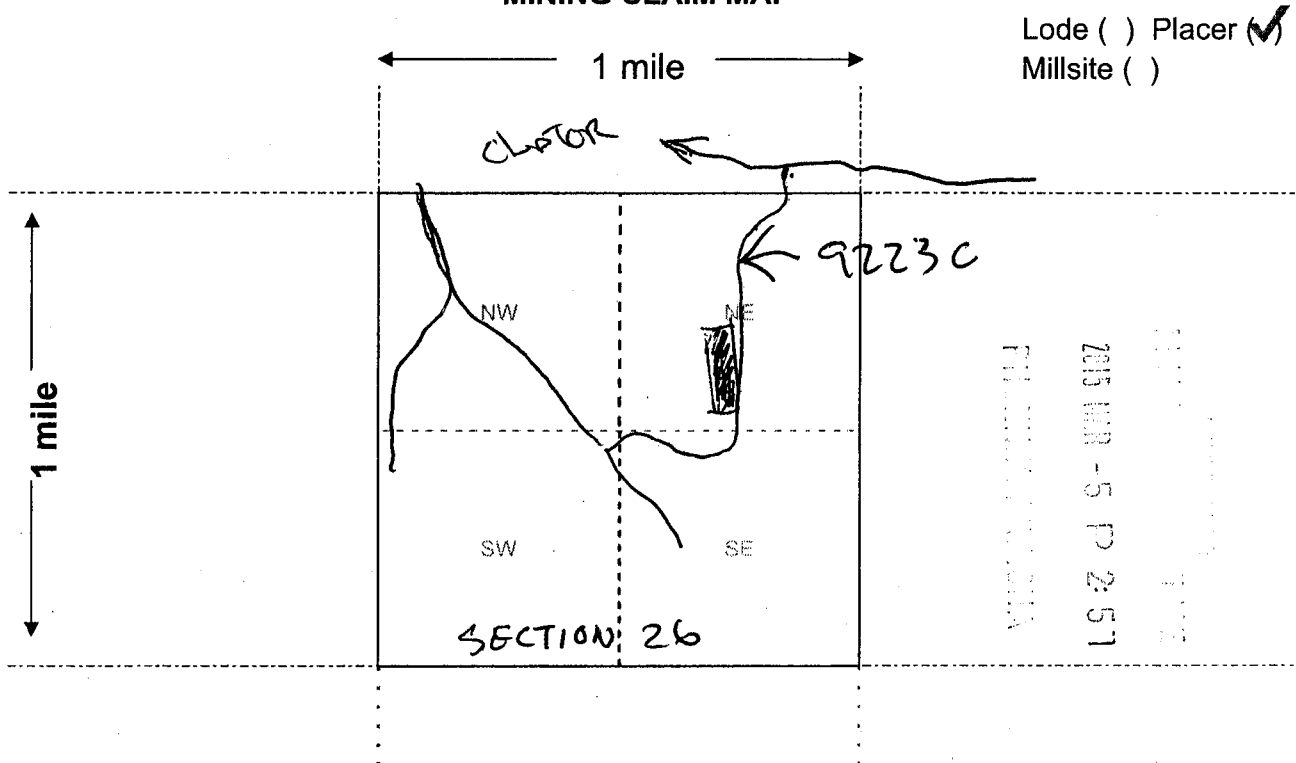

Lode ( ) Placer (✓)  
Millsite ( )

Scale: 1" = 2000 feet



1. The above map depicts the MAVERICK 6 mining claim, which is located in Section (s) 26, Township 11 NORTH, Range 1 EAST, Gila and Salt River Base and Meridian, YAVAPAI County, Arizona. Total claim acreage is 20
2. The type of corner and location monuments used are as follows: 2X2 WHITE PVC CORNER MARKERS
3. The bearings and distances in degrees and feet between claim corners and to a public land survey monument are as depicted on the map.
4. If the claim is a placer or millsite claim with exterior limits conforming to legal subdivisions of the public survey, provide a legal description of the claim \_\_\_\_\_

**Form MCF100a**  
Revised July 2014

This form is available from the **Arizona Geology Survey** and may be reproduced.

AMC430548

When Recorded Return  ment to:

CHRISTOPHER A MILLER

16170 WEST DYNAMITE BLVD

SURPRISE, AZ

85387

Check here is this is a change of address.

Telephone: \_\_\_\_\_

E-mail address: \_\_\_\_\_

**LOCATION NOTICE FOR PLACER MINING CLAIM**

Amendment BLM Serial # \_\_\_\_\_

NOTICE IS HEREBY GIVEN that the MAVERICK 7

\_\_\_\_\_ placer mining claim has been located by

CHRISTOPHER A MILLER whose current mailing

address is 16170 W DYNAMITE BLVD

SURPRISE, AZ 85387

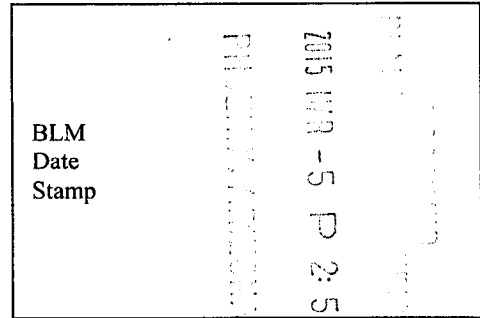

The general course of this claim is NORTHERLY and it is situated in YAVAPAI

County, Arizona. This claim is 1320 feet in length and 660 feet in width.

20 Total Claim Acreage. This claim runs from the location monument on which this location notice is

posted at the NW corner of the claim approximately 1320 feet in a EASTERLY direction to the

NE end line and 660 feet in a SOUTHERLY direction to the SE end line. This claim is marked by four monuments, one at each corner of the claim.

The location monument on which this notice is posted is situated within Section 24, Township

11 NORTH, Range 1 EAST, Gila Salt River Base and Meridian, Arizona. This claim encompasses portions of the following legal subdivision(s) if located by legal subdivision or the following quarter section(s),

section(s), Township(s) and Range(s) NW 1/4 T11 R1E

\_\_\_\_\_, Gila Salt River Base and Meridian, Arizona.

The locality of this claim with reference to some natural object or permanent monument and additional information

(if any) concerning its locality are as follows: JUST EAST OF CLEATOR, ARIZONA OFF FORREST SERVICE

ROAD 9225 A

\_\_\_\_\_ The above information is shown on the attached map.

DATED AND POSTED on the ground this 28 day of FEBRUARY, 20 15.

LOCATOR(s)  AGENT

Print Name(s) CHRISTOPHER A MILLER

Signature(s)

Form MCF102  
Revised July 2014

AMC430549



**MINING CLAIM MAP**

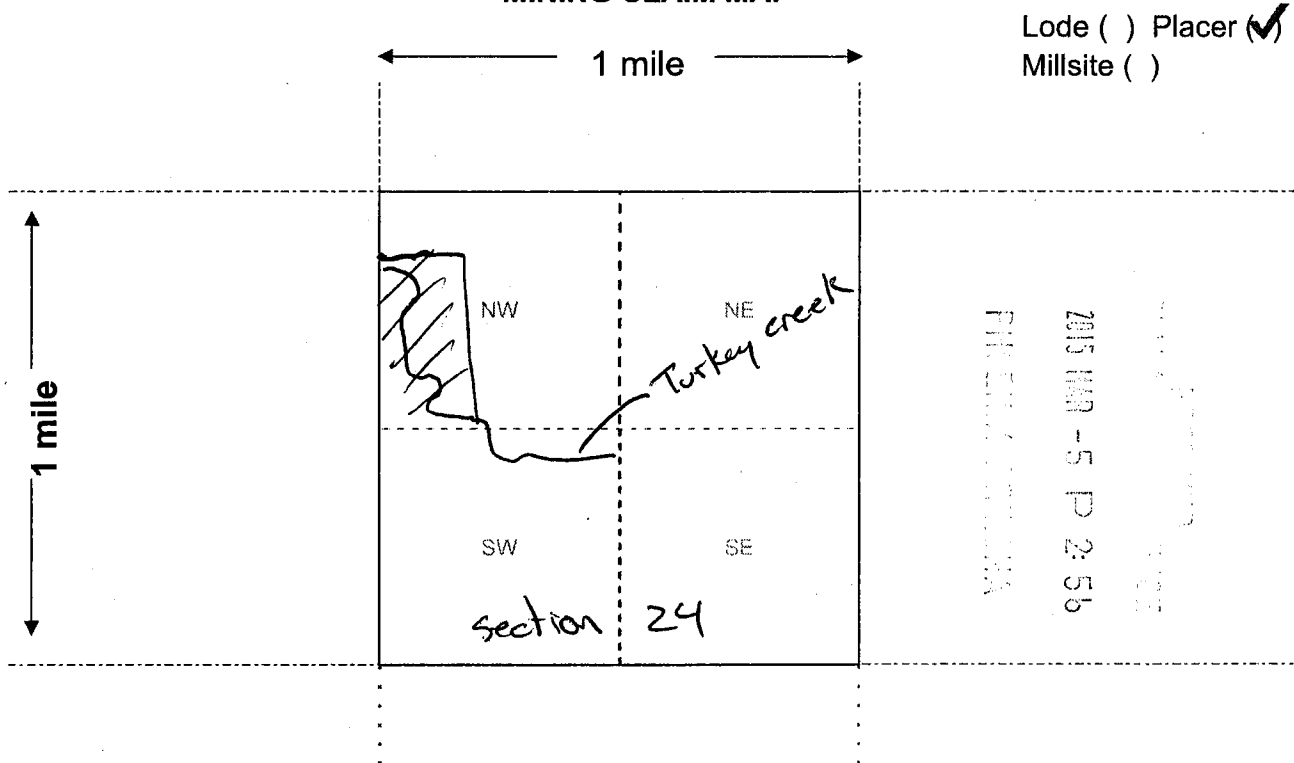

Scale: 1" = 2000 feet



1. The above map depicts the MAVERICK 7 mining claim, which is located in Section (s) 24, Township 11 NORTH, Range 1 EAST, Gila and Salt River Base and Meridian, YAVAPAI County, Arizona. Total claim acreage is 20
2. The type of corner and location monuments used are as follows: 2X2 WHITE PVC CORNER MARKERS
3. The bearings and distances in degrees and feet between claim corners and to a public land survey monument are as depicted on the map.
4. If the claim is a placer or millsite claim with exterior limits conforming to legal subdivisions of the public survey, provide a legal description of the claim \_\_\_\_\_

Form MCF100a  
Revised July 2014

This form is available from the Arizona Geology Survey and may be reproduced.

AMC430549

DEPARTMENT OF INTERIOR  
BUREAU OF LAND MANAGEMENT

Input Parameters for Geographic Report with Land

System Id = CR

Admin State = AZ

Geo State =

Casetype Begins With

Case Disp Txt = AUTHORIZED, CANCELLED, EXPIRED, PENDING, REJECTED, RELINQUISHED, WITHDRAWN

Mer Twp Rng =

Section =

Mtrs = 14 0110N 0010E 024, 14 0110N 0010E 026, 14 0110N 0010E 999

Commodity =

Commodity Txt =

Pending Org =

Pend Org Decode =

Total Rows Returned: 0



# Mass Add/Delete/Update Action Data

Starting Serial Number Ending Serial Number

430544

430549

	Action Data:
Action Code:	669 <input type="button" value="Lookup"/>
Action Remark:	Action 484 Amounts: <input type="radio"/> \$ <input type="radio"/> \$
Action Date:	04/20/2015
Receipt Nr:	

- [AMC430544] -  - 669 -
- [AMC430545] -  - 669 -
- [AMC430546] -  - 669 -
- [AMC430547] -  - 669 -
- [AMC430548] -  - 669 -
- [AMC430549] -  - 669 -

=====  
Total Amount Processed : \$0.00

	Update Action Data:
Action Code:	<input type="button" value="Lookup"/>
Action Remark:	
Action Date:	
Receipt Nr:	

Chris Miller  
16170 W Dynamite BLVD  
Surprise AZ 85387

PHOENIX AZ 852

03 MAR 2015 PM 4 L

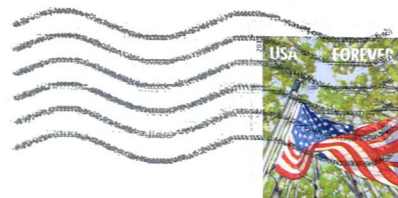

CLM A  
2015 MAR -5 P 2:50  
PHOENIX, ARIZONA

Bureau of Land Management  
Arizona State Office  
One North Central Avenue, Suite 800  
Phoenix, AZ 85004-4427

85004442700





Chris Miller

16170 W Dynamite BLVD

Surprise AZ 85387

PHOENIX AZ 852

03 MAR 2015 PM 11 L



RECEIVED  
BUREAU OF LAND MANAGEMENT OFFICE  
2015 MAR -5 P 2:51  
PHOENIX, ARIZONA

Bureau of Land Management

Arizona State Office

One North Central Avenue, Suite 800

Phoenix, AZ 85004-4427

85004442700



Chris Miller  
16170 W Dynamite BLVD  
Surprise AZ 85387

PHOENIX AZ 853

03 MAR 2015 PM 3 L



Bureau of Land Management  
Arizona State Office  
One North Central Avenue, Suite 800  
Phoenix, AZ 85004-4427

PHOENIX, ARIZONA  
2015 MAR -5 P 2:51  
BLM / BUREAU OF LAND MANAGEMENT

05004442700

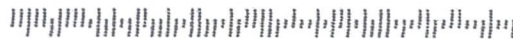

Chris Miller  
16170 W Dynamite BLVD  
Surprise AZ 85387

PHOENIX AZ 852

03 MAR 2015 PM 4 L

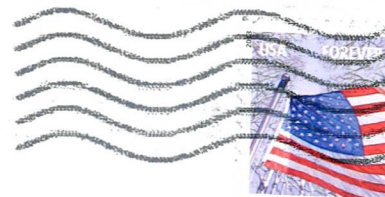

Bureau of Land Management  
Arizona State Office  
One North Central Avenue, Suite 800  
Phoenix, AZ 85004-4427

BLM  
OFFICE  
2015 MAR -5 P 2:51  
PHOENIX, ARIZONA

85004442700



Chris Miller

16170 W Dynamite BLVD

Surprise AZ 85387

PHOENIX AZ 852

03 MAR 2015 PM 8 L

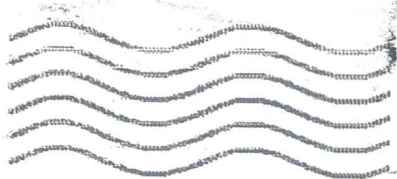

RECEIVED  
2015 MAR -5 P 2:50

PHOENIX, ARIZONA

Bureau of Land Management

Arizona State Office

One North Central Avenue, Suite 800

Phoenix, AZ 85004-4427



Chris Miller

16170 W Dynamite BLVD

Surprise AZ 85387

PHOENIX AZ 852

03 MAR 2015 PM 4 L

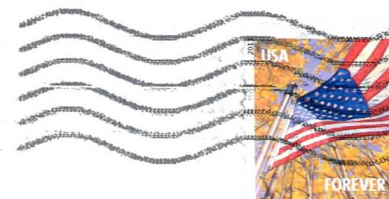

RECEIVED  
PLM  
OFFICE

2015 MAR -5 P 2:50

PHOENIX, ARIZONA

Bureau of Land Management

Arizona State Office

One North Central Avenue, Suite 800

Phoenix, AZ 85004-4427

85004 442700

